

ENDO
LIGHTING CORP.
www.endo-lighting.co.jp

Smart
LEDZ[®]
SYSTEM

 **Safety Precautions**

- Lighting fixtures have limited service lifetime.
- We recommend that you inspect and/or replace fixtures 8-10 years after installation, for they may have deteriorated on the inside even if their outward appearance seems normal.

*Use conditions: ambient temperature 30°C, 10 hours of light-up per day, 3,000 hours of light-up per year

- Higher ambient temperatures and longer light-up times will result in shorter service life.
- Please perform voluntary inspections at least once a year.
- Please have an expert (e.g. from your constructor) perform an inspection at least once every three years.
- Continued use of fixtures without inspection over long periods of time may cause them to, though rarely, smoke, catch on fire, or cause electrocution.

- Please note that products are still under development. This means that product images and specifications in this document may not be up to date.
- Some of the images and data in this document are simulations for demonstrating color and brightness. Please note that they may not necessarily represent the actual specifications.
- Please note that LED devices, due to their variable nature, may be less uniform in their color and brightness compared to more common light sources such as incandescent and fluorescent lamps.
- See Specification Diagrams to learn more about products before use.
- To use products safely, please be sure to read the User's Manuals in advance.
- Specification Diagrams and User's Manuals are published on our website.
<https://www.endo-lighting.com>

Easy, Convenient, and Flexible

The New Standard of Lighting Control

Just install your lighting fixtures—and you're all set!
An innovative dimmer application that flexibly "fits" your needs and the needs of your space.





No Additional Cost to Start

Start anytime

You can control your lighting without construction work just by installing compatible lighting fixtures. No special equipment necessary. Customize your lighting easily using your smartphone or tablet.

Flexibly make changes later

Flexibly adaptable to layout changes and fixture additions. The system allows settings to be freely changed according to the method of use.

Rapid Setup In 3 Steps

No major construction necessary

A simple system that lets you get started just by installing the fixtures.

STEP 1

Install wireless dimmer compatible fixtures



STEP 2

Download specialized app and perform settings

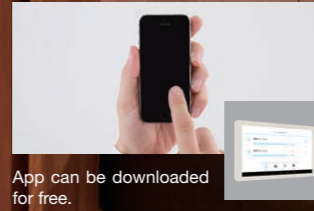

App can be downloaded for free.

STEP 3

You're all set!

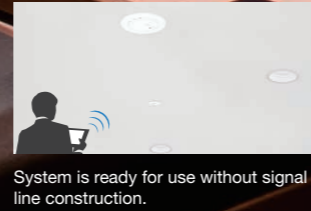

System is ready for use without signal line construction.



Easily Connectable Up to 250 units

One system supports up to 250 units.

Using the gateway, Smart LEDZ Fit can control up to 250 fixtures per system*. Also, intercommunication (2.4 GHz mesh) between lighting fixtures allows for more stable operation.

*Sensors and remote controls included in the 250 fixtures.

1 Finger Operation



駆けぬける歓び

Welcome

Easy and intuitive operation at the touch of a finger

Specialized app (free to download) that supports commercially available tablets and smartphones. Its intuitively usable interface allows anyone to access a diverse variety of dimming features, such as individual control and scene switching, at the touch of a finger, without any special training.



What is Smart & Fit ?

More Useful and Affordable than Manual Dimmers!

Costs less than using manual dimmers, even if you employ a Gateway for automatic operation.

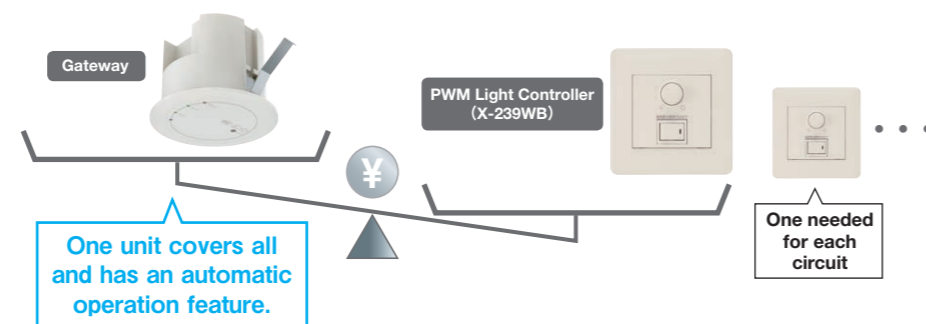

A great "fit" even for those who want to "start small."

Initial cost comparison between wired dimmer system and Smart LEDZ Fit

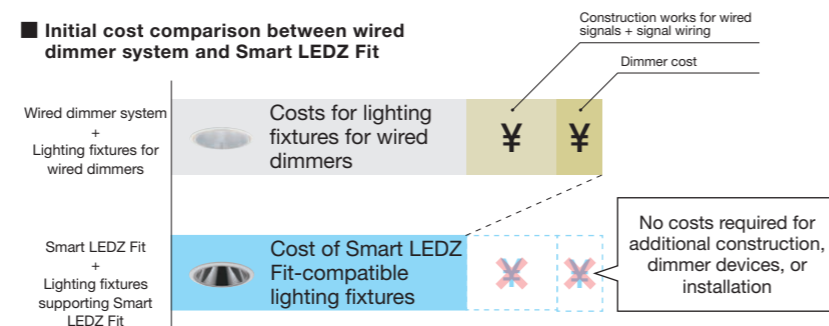

Configuration for wired dimmer lighting systems

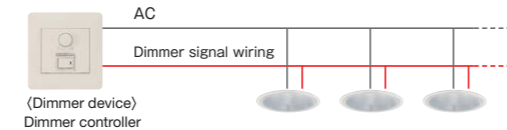

Configuration for Smart LEDZ Fit

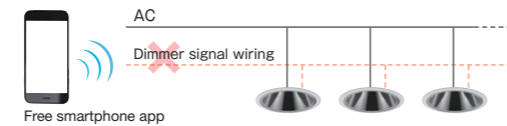

Scalable to suit your needs

A simple system configuration coupled with versatile setup features. A rich array of useful features such as set data saving and copying.

System Configuration

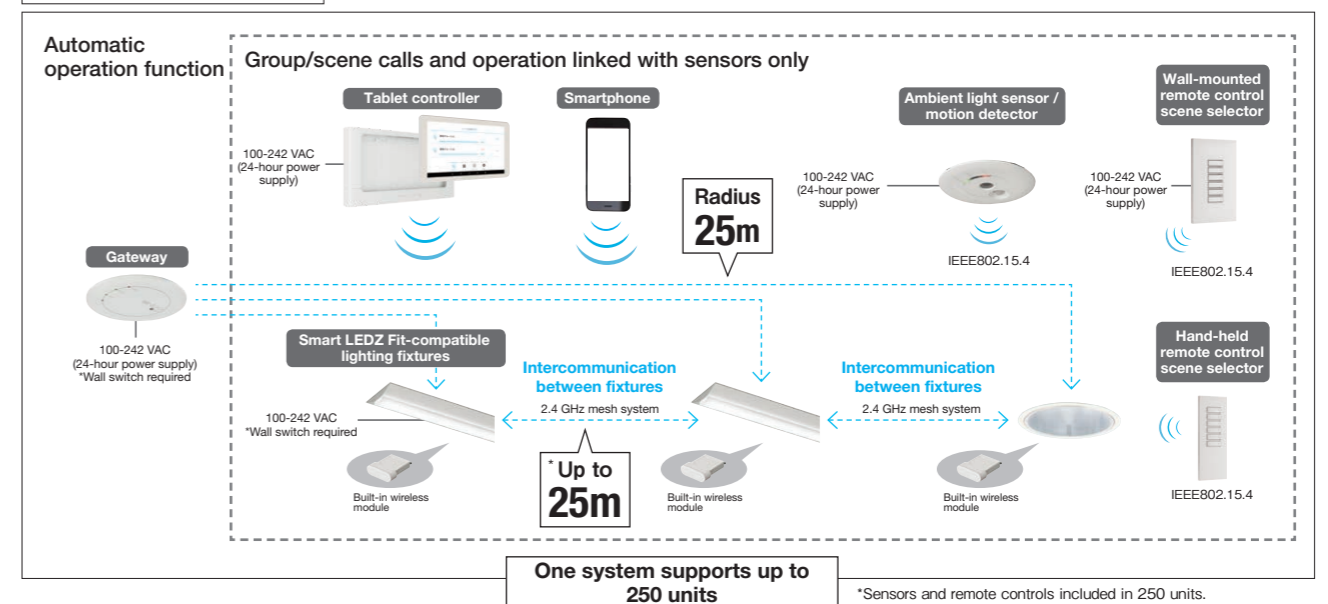

A New, More Reliable Communication System

Newly adopted intercommunication method where signals are relayed, enabling them to go around obstacles, making it easier to connect than in conventional systems.

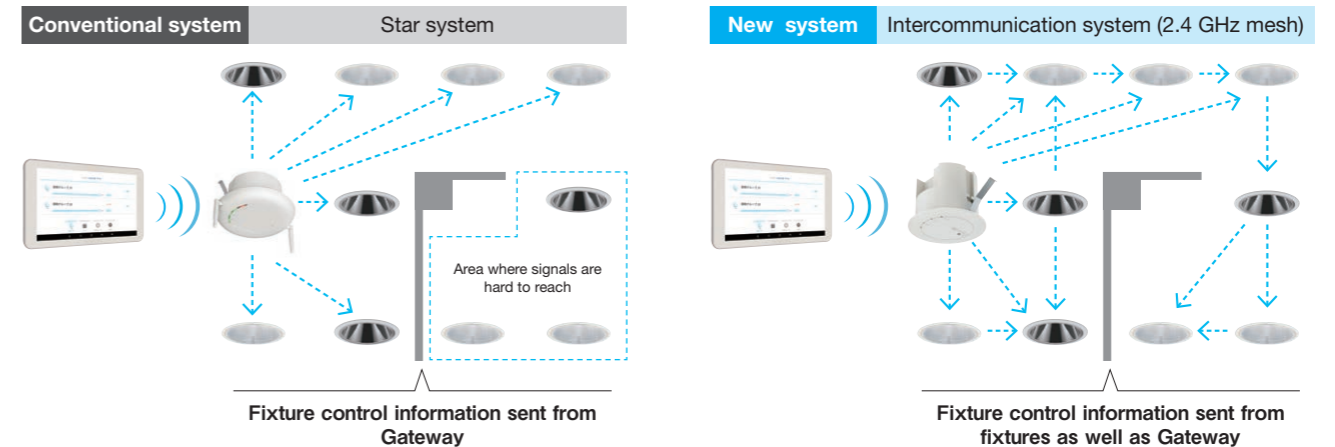



Select the system according to your purpose

You can choose an affordable "investment" to suit your purpose.

Smart LEDZ Fit MAX 250 UNITS			Smart LEDZ Fit Plus MAX 30,000 UNITS	
1	2	3	4	5
Easy to start!	Easy to start without using a personal smartphone	Automatic timed control	Control numerous lighting fixtures	Control numerous lighting fixtures linked with other equipment

*The same lighting fixtures are used for both Fit and Fit Plus.

1	2	3	4	5
Smartphone/tablet app	Tablet	Smartphone/tablet app Tablet	Tablet	Tablet
—	—	Dedicated gateway for Smart LEDZ Fit Up to 1 unit	Dedicated gateway for Smart LEDZ Fit Plus Up to 12 units	Dedicated gateway for Smart LEDZ Fit Plus Up to 12 units
—	—	—	—	Centralized management software EMS unit

Expand features by adding options!

Handy remote controller scene selector Allows you to switch scenes with the touch of a button	Wall-mounted remote control scene selector	Ambient light sensor / motion detector Controls lighting fixtures according to ambient brightness and how people move	Non-voltage a-contact unit Enables wireless control of lighting fixtures without dimming control*	PWM signal unit Enables wireless control of PWM lighting fixtures
--	--	--	--	--

*Requires remote control breaker with a-contact input. Dimming not supported; lights can only be turned on or off. See specifications diagram for details.

Basic features Feature expansion options 	Basic features Feature expansion options 	Basic features Feature expansion options 	Basic features Feature expansion options 	Basic features Feature expansion options
---	---	---	---	---

- Individual control
- Scene switching
- Maintains appropriate illuminance
- Maintains illuminance by utilizing daylight
- Illuminance control using motion sensor
- Illuminance scheduling
- Expansion of controllable units
- Lighting fixture layout
- Centralized control
- Linked with external equipment



Setting and operation are intuitive!

The location of the lighting fixtures is displayed on the tablet, therefore grouping and manipulation of the lighting fixtures are intuitive. Since grouping can be performed in advance, it is possible to shorten the setting time at the site.

Main Features

Individual control

Allows you to control each lighting fixture individually to fine-tune your lighting environment.

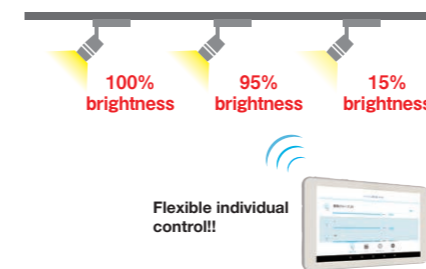

Scene switching

Allows you to call the scene that best suits your settings.



*In closed-off spaces such as conference rooms and office rooms, remote controls are convenient. Up to 6 scenes can be set and registered on a single remote control.

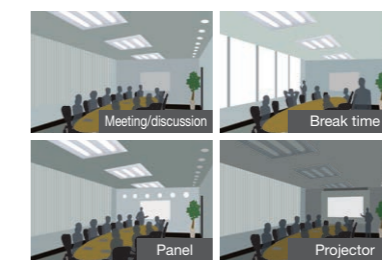

Scheduling

Different brightness settings can be set for different times of the day or according to your weekly schedule.

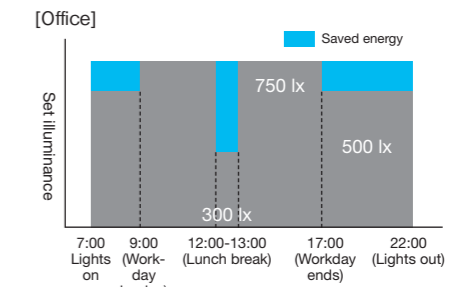

Maintaining appropriate illuminance

Ambient light sensor detects brightness to automatically make adjustments to match your illuminance settings. Energy saving is realized through maintaining appropriate illuminance.



*Cannot be used together with scene/scheduling features

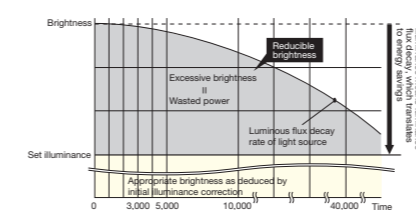

Maintaining appropriate illuminance by utilizing daylight

Ambient light sensor / motion sensor automatically detects the brightness of natural light to maintain appropriate illuminance, both day and night.



*Cannot be used together with scene/scheduling features

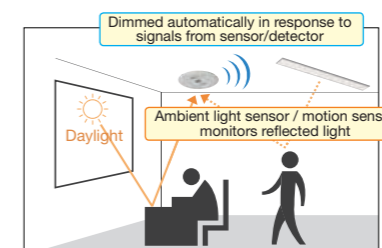

Illuminance control using motion sensor

Saves energy by setting brightness according to space usage conditions.



*Cannot be used together with scene/scheduling features

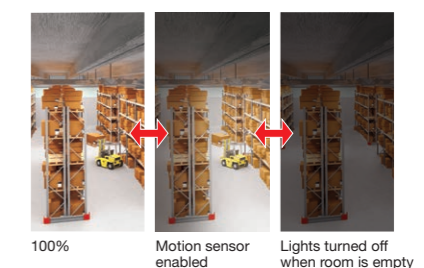

10,000 use cases

Employed and favorably received in many projects



Morning

Olinas Mall Core

Owner: CapitalLand (Japan) Kabushiki Kaisha
 Environmental Design: Bauhaus Maruei Co., Ltd.
 Construction: Tokyu Construction Co., Ltd.



Daytime



Night



You can feel sky through indirect lighting fixtures

Color temperature changes in conjunction with light from outside. The effects tailored to the time zone make the ceiling freedom like sky. In addition, it is possible to create effects that people can feel the time lapse on the wall surface of room.

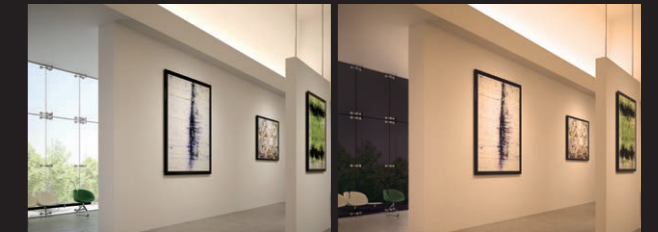

Morning : 5000K

Evening : 2700K

You can emphasize the object by color tuning

Illuminating at a color temperature slightly higher than the surrounding environment makes the object prominent and increases visibility from remote locations.



No dimming : All 3500K

Dimming : VIP effect 4000K

You can control lighting fixtures with general PC at a low cost. It is possible to control and operate 30,000 lightings fixtures.

By using central control software, maximum 30,000 lighting fixtures for 10 systems can be controlled and operated by general PC. Complicated systems and personal computers are not required, therefore the cost of installation can be drastically reduced and operators can enhance efficiency of operation.

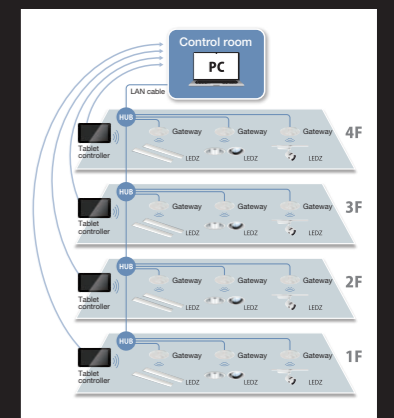
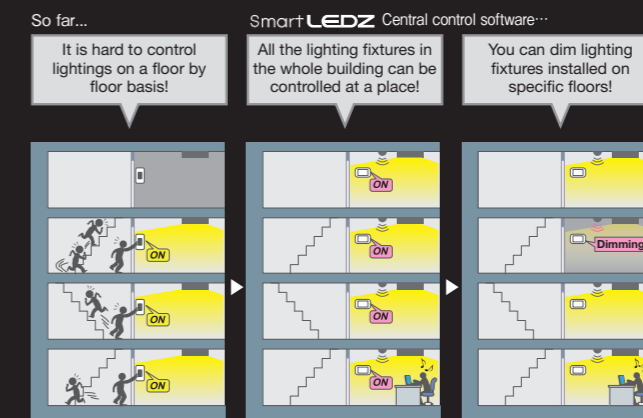

Projects



Prism Hall, Tokyo Dome City

Place: Bunkyo-ku, Tokyo
Owner: Tokyo Dome Corporation
Design: PARCO Space Systems Co., Ltd.

Prism Hall, Tokyo Dome City is an event hall operated by Tokyo Dome Corporation and 2,000 people can stay in the hall. It is used for a wide range of purposes such as exhibition, sales meeting, various seminars and events because of that JR Suidobashi station, Tokyo Metro Marunouchi line and several stations such as Korakuen station are close to the hall and traffic access is excellent. In the hall, central control system was introduced from the viewpoint of Smart LEDZ and management system so that it can correspond to a wide variety of application in line with conventional lighting fixtures to LED.



Large-scale individual dimming and total dimming can be easily achieved by tablet control at the site and central control by PC.

In this project, approximately 600 fluorescent lamps were replaced with 300 base-lighting fixtures and 300 ceiling-downlights. At the same time, the project adopted Smart LEDZ that allow light to be controlled without changing lighting fixtures and wires for each event. The tablet is handed over to event company in charge of the construction of each event, and lighting control in line with the concept of the event can be done at the site. In addition, the hall is divided by partitions, and there are many cases where multiple events are held. If there are Smart LEDZ, you can dim each of the areas. Furthermore, from the state that each of event companies dims lighting fixtures separately, it is possible to turn back to the state before the events by central control system in the control room. As a result, light environment wanted by event companies can be faithfully produced at the site, and lighting management such as restoration by facilities manager becomes easier.



Ito-Yokado No Yakitate Pan, Higashiyamato Store

Owner: Ito-Yokado Co., Ltd.

Smart LEDZ can create a flow of light that is in harmony with the optimal light environment and human senses tailored to the day's movement.

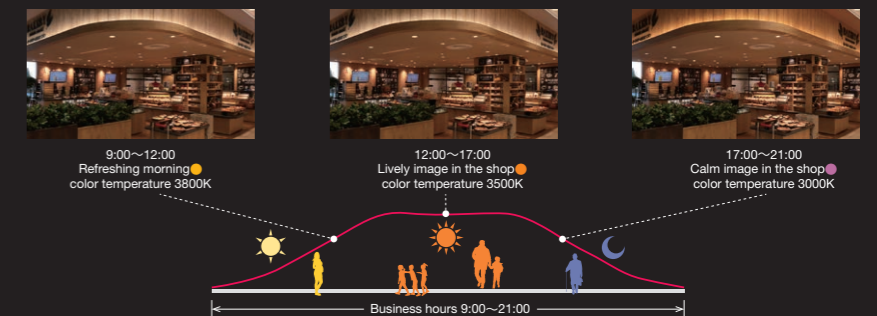

Dimming and color tuning based on internal rhythm and external light

If you use Smart LEDZ scheduling function for dimming and color tuning in conjunction with internal rhythm (circadian rhythm), you will be able to make suitable effects in the morning, day time and night as customers can feel relaxed in the shop. As the result, wasteful power consumption is reduced, leading to reduction in power consumption throughout the year.

Reduction in power consumption by approximately **28%** compared with conventional lighting fixtures

Power consumption simulation			
		Power consumption (W)	Annual power consumption (kWh)
LEDZ	100% lighting on	3237	14,178
Smart LEDZ Schedule control	Morning		
	Daytime	2317	10,148
	Night		

Quantities and lighting times are simulations of assumptions. Difference in electric energy **4,030kWh**

Lighting day per year : 365 days per year
 Lighting time: 12 hours per day

Approximately **28%** reduction



Making dimming and color tuning more accessible — A proposal that “fits” your needs!

Dimming and color tuning for your entire space

Products in our new Dimming and Light Tunable Series all have a color tuning range of 6500K-2700K. This allows you to collectively adjust all fixtures in your configured group to the same color temperature and dimming rate. You can easily make dynamic spatial presentations.

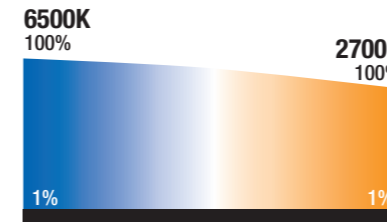

Easier construction and configuration

Previously, two power units were required for each fixture, which meant that two units needed to be registered to the controller as well. For this new product line, we made changes so that only one power unit is required per fixture, thereby improving workability and making registration and configuration easier.

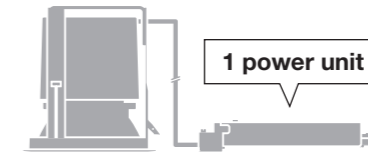

More intuitive operations

Dimming and color tuning can now be performed separately. Adjustments for individual fixtures, entire groups, etc. can be made intuitively and easily through on-screen operations.

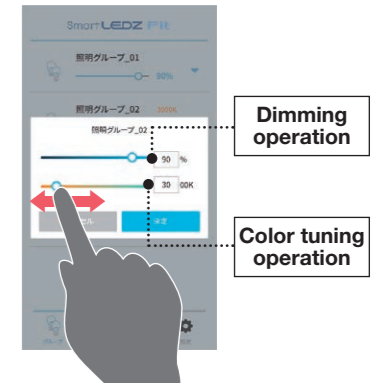

For example, at a restaurant...

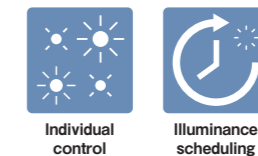

A space that is hospitable any time of the day.

Brightness and color temperatures can be set according to the time of day, in accordance with the daily schedule, to deliver a comfortable atmosphere. You can also set light-up times according to the weekly schedule to fit changes in business hours, or change your settings to accommodate special events, irregular occasions, and so forth.

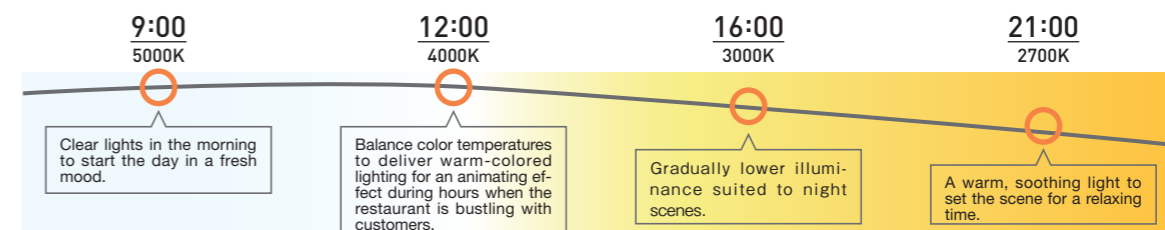
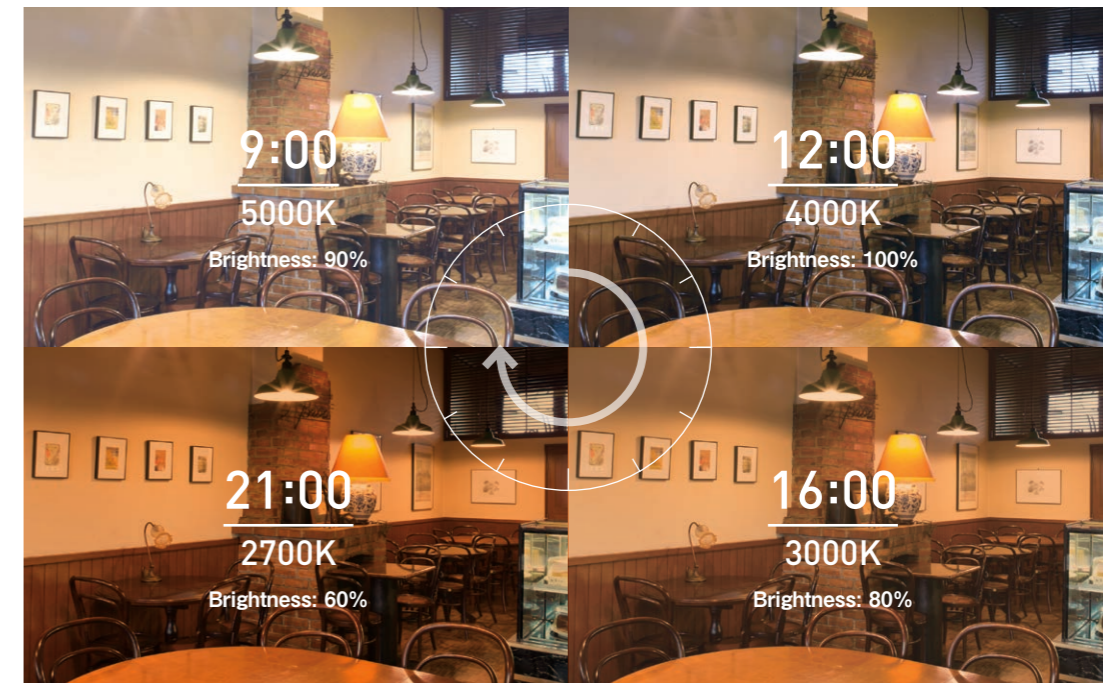

Smart LEDZ System Product List

Ambient Light Sensor / Motion Sensor

Fit/Fit Plus Combination
FX-428W
FX-428B

Body: Plastic (white matt finish / black matt finish)
 Weight: 0.2kg Rated voltage: 100-242 VAC: ϕ 75 Adjustable sensor sensitivity
 Built-in wireless module 2 light-proof stickers included
 Cannot be installed with thermal insulation
 Ambient light sensor mode: Only 1 unit can be registered for each group
 Motion detector mode: Up to 10 units can be registered for each group
 • 24-hour power supply is required.
 • This device uses intercommunication. Please install at least one system device within 25 m (line of sight). The accuracy of communication increases the more devices there are in the line of sight.
 • Can be used with Smart LEDZ Fit/Fit Plus compatible fixtures.

Registered Design

Direct-mount Bracket for Illuminance Sensor and Human Sensor
FX-269W
FX-269B

Body: White/black

NEW

Handy Remote Controller Scene Selector

Fit/Fit Plus Combination
FX-431W

Body: Plastic (white) Weight: 0.1kg
 Power: 2 x AAA batteries Built-in wireless module
 With wall bracket Switchable for up to 6 scenes
 Up to 10 units can be registered per system.
 • Up to 10 units can be registered in total with the Wall-mounted Remote Control Scene Selector and the Handy Remote Controller Scene Selector.
 • Can be used with Smart LEDZ Fit/Fit Plus compatible fixtures.

Patented

Wall-mounted Remote Control Scene Selector

Fit/Fit Plus Combination
FX-427W

Body: Plastic (white) Weight: 0.1kg
 Rated voltage: 100-242 VAC
 Compatible with commercially available JIS-compliant single switch boxes.
 Built-in wireless module Switchable for up to 6 scenes
 Up to 10 units can be registered per system
 • Up to 10 units can be registered in total with the Wall-mounted Remote Control Scene Selector and the Handy Remote Controller Scene Selector.
 • 24-hour power supply is required.
 • This device uses intercommunication. Please install at least one system device within 25 m (line of sight). The accuracy of communication increases the more devices there are in the line of sight.
 • Can be used with Smart LEDZ Fit/Fit Plus compatible fixtures.

Patented

Non-voltage A-contact Unit

Fit/Fit Plus Combination
FX-440W
FX-440B

Body: Plastic (white matt finish / black matt finish)
 Weight: 0.2kg Rated voltage: 100-242 VAC: ϕ 75 Built-in wireless module
 Cannot be installed with thermal insulation
 Non-voltage a-contact output 100 VAC/30 VDC
 • 24-hour power supply is required.
 • This device uses intercommunication. Please install at least one system device within 25 m (line of sight). The accuracy of communication increases the more devices there are in the line of sight.
 • Do not install in a distribution panel.

Notes • When controlling lighting fixtures, use LED lamps only.
 • To control a fixture, use a "remote control breaker (always excited, a-contact type)."
 • The contact circuit voltage of this unit should not exceed 100 VAC/30 VDC.
 • This unit cannot be used in conjunction with the illuminance sensor and human sensor (FX-428W/B). (Can be linked for human sensor mode.)

PWM Signal Unit

Fit/Fit Plus Combination
FX-441W
FX-441B

Body: Plastic (white matt finish / black matt finish)
 Weight: 0.2kg Rated voltage: 100-242 VAC: ϕ 75 Built-in wireless module
 Cannot be installed with thermal insulation
 PWM signal output PWM dimming signal output line (CPEV-1P/0.9) must not exceed 100 m in total wiring length. Each Signal Unit can be connected to a maximum of 50 PWM lighting fixtures.
 • 24-hour power supply is required.
 • This device uses intercommunication. Please install at least one system device within 25 m (line of sight). The accuracy of communication increases the more devices there are in the line of sight.
 • Do not install in a distribution panel.
 • The dimming range is limited by the dimming range of the PWM lighting fixtures.

Phase Dimming Unit

Fit/Fit Plus Combination
FX-426N

Weight: 0.3kg Input voltage: 100 VAC (50/60 Hz)
 Built-in wireless module
 Cannot be installed with thermal insulation
 Applicable load: 4 VA to 300 VA
 • A minimum 75-mm dia. opening is required for ceiling mounting.
 • Must be used in combination with a Smart LEDZ Fit/Fit Plus system.

Contact Converter

For Fit Plus only
FX-304W

Power consumption: 3.0W Body: Plastic (white)
 Weight: 0.3kg Dimensions: 30 H x 140 W x 60 D
 Rated voltage: 100-242 VAC
 Power adapter included: a(b) contact input

Notes • This device cannot be used alone. Use only with a Model FX-438N Smart LEDZ Fit Plus Dedicated Tablet Controller (with AC adapter) and a Model FX-430W/B Smart LEDZ Fit Plus Dedicated Gateway.
 • Use only the supplied power adapter.

Centralized Management Software

For Fit Plus only
FX-439N NEW

Windows 7 and above are supported. Max. number of controllable systems: 10

Notes • When connecting to a wired LAN, use a commercially available hub.
 • Computer not included; a customer-supplied unit is required.

EMS Unit

For Fit Plus only
FX-452N NEW

Smart LEDZ Fit Plus: Manages 1 system (up to 3,000 units).

Tunable LEDZ LINE UP

Downlight

Brightness	Downlight							
	200		125		100		75	
	Cone: Mirror matt finish Cut-off angle: 30°	Cone: White Cut-off angle: 20°	Cone: Mirror matt finish Cut-off angle: 30°	Cone: White Cut-off angle: 20°	Cone: Mirror matt finish Cut-off angle: 30°	Cone: White Cut-off angle: 15°	Cone: Mirror matt finish Cut-off angle: 30°	Cone: Black/White Cut-off angle: 30°
9000TYPE								
7500TYPE								
4000TYPE								
3000TYPE								
1400TYPE								
900TYPE								

Tunable Linear Light

Brightness: 6500K-2700K

2800 lm (L: 1200) **Linear 32**

1500 lm (L: 1200) **Linear T5**

575 lm (L: 1250) **High-powered Flexible Lighting**

2800 lm (L: 1500) **Linear 32**

2500 lm (L: 1200) **Linear 32**

Comfort Tunable White 3000K-2000K

Brightness: 6500K-2700K

6300 lm (L: 1200TYPE) **Linear 50**

2800 lm (L: 1200TYPE) **Linear 32**

Surface mounted type Recessed type Slit type Recessed open type Recessed open deep type

Surface-mounted/Pendant type Surface-mounted/Pendant type Bracket type (up and down light distribution)

Surface mounted type Recessed type Slit type Recessed open type Wall-washer type

Surface-mounted/Pendant type Bracket type (upper light distribution)

Surface mounted type Bracket type (upper light distribution)

Tunable LEDZ



Tunable Glare-less Downlight

Suppress unpleasant brightness with Light Distribution Control.

The combination of a light-diffusing design that minimizes visibility of the lamp in the cone and a mirror-surface cone reduces brightness. The result is a glare-less fixture that doesn't draw attention to itself.

The refined design effectively hides the edge behind the cone and eliminates unpleasant brightness.



Comparison of cone brightness

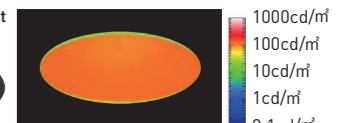
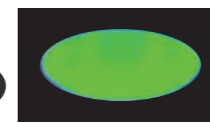

Tunable Adjustable Downlight / Tunable Glare-less Downlight / Tunable Glare-less Adjustable Downlight

Brightness	Tunable adjustable downlight		Tunable glare-less downlight			Tunable glare-less adjustable downlight		
	100	75	125	100	75	125	100	75
9000TYPE								
7500TYPE								
4000TYPE								
3000TYPE								
1400TYPE								
900TYPE								

Tunable Base Light: SD Series 6500K-2700K

Brightness	Surface mounted type							Recessed		
	6900 lm TYPE 5200 lm TYPE 4Feet							6900 lm TYPE 5200 lm TYPE 4Feet		

Tunable Square Panel Light 6500K-2700K

Brightness	Surface mounted type		Recessed	
	600 Series		450 Series	
11000 lm TYPE				
6000 lm TYPE				
2700 lm TYPE				

125 3000TYPE



LED module included
Frame: Die-cast aluminum (matt white)
Cone: Aluminum (mirror finish)
Driver sold separately
Cannot be installed with thermal insulation
LED module cannot be replaced

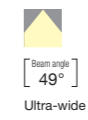

6500K-2700K CRI85
ERD7602W
Rated luminous flux 1689lm
27.5W 61.4lm/W
*At 5000K

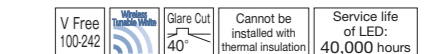

Sold separately
Dedicated separate power supply unit
Fit/Fit PLUS NEW
FX-433N
Weight: 1.1kg (including body)
Dimensions H: 40 L: 257
Wireless module included
Dimming rate: 1-100%

100 1400TYPE



LED module included
Frame: Die-cast aluminum (W: matt white / B: matt black)
Cone: Aluminum (mirror finish)
Driver sold separately
Cannot be installed with thermal insulation
LED module cannot be replaced
Lens/honeycomb accessories are not available

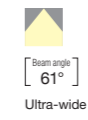

6500K-2700K CRI85
ERD8478W (white)
ERD8478B (black)
Rated luminous flux 1068lm
14.8W 72.1lm/W
*At 5000K

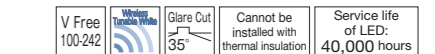

Sold separately
Dedicated separate power supply unit
Fit/Fit PLUS NEW
FX-432N
Dimensions H: 38 L: 225
Wireless module included
Dimming rate: 1-100%
* Cannot be installed if there is an obstacle within 150 mm from the ceiling surface.

100 900TYPE



LED module included
Frame: Die-cast aluminum (W: matt white / B: matt black)
Cone: Aluminum (mirror finish)
Driver sold separately
Cannot be installed with thermal insulation
LED module cannot be replaced
Lens/honeycomb accessories are not available

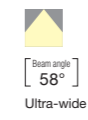

6500K-2700K CRI85
ERD7603W (white)
ERD7603B (black)
Rated luminous flux 757lm
10.1W 74.9lm/W
*At 5000K

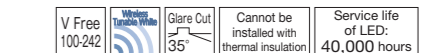

Sold separately
Dedicated separate power supply unit
Fit/Fit PLUS NEW
FX-432N
Weight: 0.8kg (including body)
Dimensions H: 38 L: 225
Wireless module included
Dimming rate: 1-100%
* Cannot be installed if there is an obstacle within 150 mm from the ceiling surface.

75 900TYPE



LED module included
Frame: Die-cast aluminum (W: matt white / B: matt black)
Cone: Aluminum (mirror finish)
Driver sold separately
Cannot be installed with thermal insulation
LED module cannot be replaced
Lens/honeycomb accessories are not available

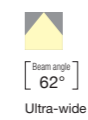

6500K-2700K CRI85
ERD7608W (white)
ERD7608B (black)
Rated luminous flux 697lm
10.1W 69.0lm/W
*At 5000K

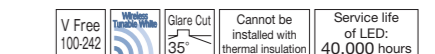

Sold separately
Dedicated separate power supply unit
Fit/Fit PLUS NEW
FX-432N
Weight: 0.6kg (including body)
Dimensions H: 38 L: 225
Wireless module included
Dimming rate: 1-100%
* Cannot be installed if there is an obstacle within 150 mm from the ceiling surface.

Tunable LEDZ



Tunable Glare-less Adjustable Downlight



For Beautiful Night-time Scenery

Since the fixture hides the actual lamp, high-quality interiors can be designed without the lamp entering the field of view. Reflections on window glass are minimized, adding to the beauty of evening and night-time views.



Glare-less mirrored cone
Nighttime scenery looks even more appealing thanks to the reduction of glare on the window glass.

General-purpose mirrored cone (silver)
Glare readily appears on the window glass.

125 ● 3000TYPE



LED module included
Frame: Die-cast aluminum (matt white)
Cone: Aluminum (mirror finish)
Driver sold separately
Cannot be installed with thermal insulation
LED module cannot be replaced



6500K-2700K CRI85

ERD7604W
Rated luminous flux 1641lm
27.5W 59.6lm/W
* At 5000K

ERD7605W
Rated luminous flux 2053lm
27.5W 74.6lm/W
* At 5000K

Power consumption
27.5W [100-242V]

Sold separately
Dedicated separate power supply unit
FX-433N
Weight: 1.3kg (including body)
Dimensions H: 40 L: 257
Wireless module included
Dimming rate: 1-100%



100 ● 1400TYPE



LED module included
Frame: Die-cast aluminum (W: matt white / B: matt black)
Cone: Aluminum (mirror finish)
Driver sold separately
Cannot be installed with thermal insulation
LED module cannot be replaced



6500K-2700K CRI85

ERD8476W (white)
ERD8476B (black)
Rated luminous flux 1017lm
14.8W 68.7lm/W
* At 5000K

ERD8477W (white)
ERD8477B (black)
Rated luminous flux 1017lm
14.8W 68.7lm/W
* At 5000K

Power consumption
14.8W [100-242V]

Sold separately
Dedicated separate power supply unit
FX-432N
Dimensions H: 38 L: 225
Wireless module included
Dimming rate: 1-100%

* Cannot be installed if there is an obstacle within 150 mm from the ceiling surface.



100 ● 900TYPE



LED module included
Frame: Die-cast aluminum (W: matt white / B: matt black)
Cone: Aluminum (mirror finish)
Driver sold separately
Cannot be installed with thermal insulation
LED module cannot be replaced



6500K-2700K CRI85

ERD7606W (white)
ERD7606B (black)
Rated luminous flux 689lm
10.1W 68.2lm/W
* At 5000K

ERD7607W (white)
ERD7607B (black)
Rated luminous flux 768lm
10.1W 76.0lm/W
* At 5000K

Power consumption
10.1W [100-242V]

Sold separately
Dedicated separate power supply unit
FX-432N
Weight: 0.9kg (including body)
Dimensions H: 38 L: 225
Wireless module included
Dimming rate: 1-100%

* Cannot be installed if there is an obstacle within 150 mm from the ceiling surface.



75 ● 900TYPE



LED module included
Frame: Die-cast aluminum (W: matt white / B: matt black)
Cone: Aluminum (mirror finish)
Driver sold separately
Cannot be installed with thermal insulation
LED module cannot be replaced



6500K-2700K CRI85

ERD7609W (white)
ERD7609B (black)
Rated luminous flux 464lm
10.1W 45.9lm/W
* At 5000K

ERD7610W (white)
ERD7610B (black)
Rated luminous flux 605lm
10.1W 59.9lm/W
* At 5000K

Power consumption
10.1W [100-242V]

Sold separately
Dedicated separate power supply unit
FX-432N
Weight: 0.7kg (including body)
Dimensions H: 38 L: 225
Wireless module included
Dimming rate: 1-100%

* Cannot be installed if there is an obstacle within 150 mm from the ceiling surface.



Tunable LEDZ



Tunable Fixed Downlight

Our varied line of differing sizes and brightness levels meets the needs of small spaces and larger facilities alike.



200 ● 9000TYPE



LED module included
Frame: Die-cast aluminum (matt white)
Cone: Aluminum (matt mirror finish)
Driver sold separately
Cannot be installed with thermal insulation
LED module cannot be replaced



6500K-2700K CRI85

ERD7583W
Rated luminous flux 1040lm
102.4W 101.5lm/W
* At 5000K

Power consumption
102.4W [100-242V]

Sold separately
Dedicated separate power supply unit
FX-436N
Weight: 2.6kg (including body)
Dimensions H: 43 L: 270
Wireless module included
Dimming rate: 1-100%

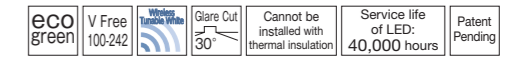

200 ● 9000TYPE



LED module included
Frame: Die-cast aluminum (matt white)
Cone: Aluminum (matt white)
Driver sold separately
Cannot be installed with thermal insulation
LED module cannot be replaced



6500K-2700K CRI85

ERD7584W
Rated luminous flux 10634lm
102.4W 103.8lm/W
* At 5000K

Power consumption
102.4W [100-242V]

Sold separately
Dedicated separate power supply unit
FX-436N
Weight: 2.5kg (including body)
Dimensions H: 43 L: 270
Wireless module included
Dimming rate: 1-100%

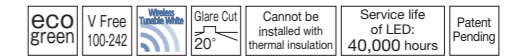

200 ● 7500TYPE



LED module included
Frame: Die-cast aluminum (matt white)
Cone: Aluminum (matt mirror finish)
Driver sold separately
Cannot be installed with thermal insulation
LED module cannot be replaced



6500K-2700K CRI85

ERD7585W
Rated luminous flux 7587lm
78.1W 97.1lm/W
* At 5000K

Power consumption
78.1W [100-242V]

Sold separately
Dedicated separate power supply unit
FX-435N
Weight: 1.9kg (including body)
Dimensions H: 43 L: 270
Wireless module included
Dimming rate: 1-100%

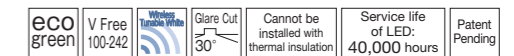

200 ● 7500TYPE



LED module included
Frame: Die-cast aluminum (matt white)
Cone: Aluminum (matt white)
Driver sold separately
Cannot be installed with thermal insulation
LED module cannot be replaced



6500K-2700K CRI85

ERD7586W
Rated luminous flux 7760lm
78.1W 99.3lm/W
* At 5000K

Power consumption
78.1W [100-242V]

Sold separately
Dedicated separate power supply unit
FX-435N
Weight: 1.9kg (including body)
Dimensions H: 43 L: 270
Wireless module included
Dimming rate: 1-100%

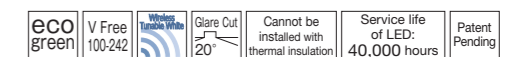

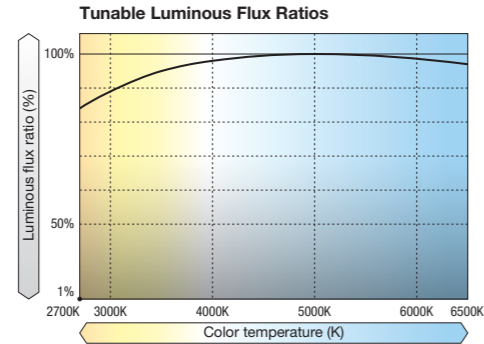

Notes:

- At a color temperature of 5000K, the change in luminous flux due to tuning is indexed as 100%.
- The ratio curve depicted above represents typical values. Some variation occurs depending on the fixtures used and the dimming level setting.
- Due to the characteristics of LEDs, variations in light color may increase at dimming rates of 10% or less.

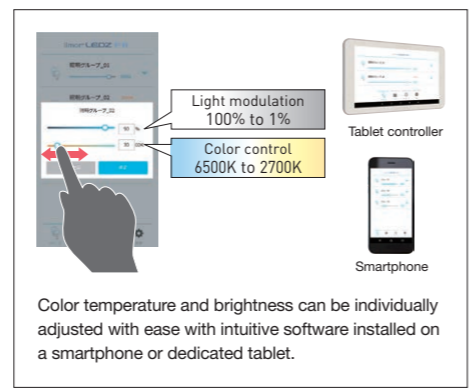

Tunable LEDZ

Fit/Fit Plus Wireless Tunable White Tunable Fixed Downlight (CORE75)

A wide product line of compact fixtures (75-mm dia.)



125 ● 4000TYPE



LED module included
Frame: Die-cast aluminum (W: matt white / B: matt black)
Cone: Aluminum (matt mirror finish)
Driver sold separately
Cannot be installed with thermal insulation
LED module cannot be replaced

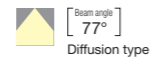

6500K-2700K CRI85

ERD7587W (white)
ERD7587B (black)
Power consumption
36.7W [100-242V]
Rated luminous flux 3595lm
36.7W 97.9lm/W
*At 5000K

Sold separately
Dedicated separate power supply unit
Fit/Fit Plus NEW
FX-434N
Weight: 1.3kg (including body)
Dimensions H: 40 L: 257
Wireless module included
Dimming rate: 1-100%

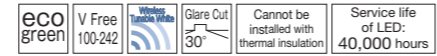

125 ● 4000TYPE



LED module included
Frame: Die-cast aluminum (matt white)
Cone: Aluminum (matt white)
Driver sold separately
Cannot be installed with thermal insulation
LED module cannot be replaced

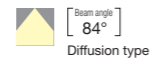

6500K-2700K CRI85

ERD7588W
Power consumption
36.7W [100-242V]
Rated luminous flux 3687lm
36.7W 100.4lm/W
*At 5000K

Sold separately
Dedicated separate power supply unit
Fit/Fit Plus NEW
FX-434N
Weight: 1.3kg (including body)
Dimensions H: 40 L: 257
Wireless module included
Dimming rate: 1-100%

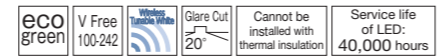

100 ● 3000TYPE



LED module included
Frame: Die-cast aluminum (W: matt white / B: matt black)
Cone: Aluminum (matt mirror finish)
Driver sold separately
Cannot be installed with thermal insulation
LED module cannot be replaced



6500K-2700K CRI85

ERD7589W (white)
ERD7589B (black)
Power consumption
27.5W [100-242V]
Rated luminous flux 2693lm
27.5W 97.9lm/W
*At 5000K

Sold separately
Dedicated separate power supply unit
Fit/Fit Plus NEW
FX-433N
Weight: 1.1kg (including body)
Dimensions H: 40 L: 257
Wireless module included
Dimming rate: 1-100%

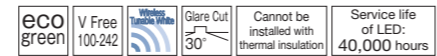

100 ● 3000TYPE



LED module included
Frame: Die-cast aluminum (matt white)
Cone: Aluminum (matt white)
Driver sold separately
Cannot be installed with thermal insulation
LED module cannot be replaced



6500K-2700K CRI85

ERD7590W
Power consumption
27.5W [100-242V]
Rated luminous flux 2973lm
27.5W 108.1lm/W
*At 5000K

Sold separately
Dedicated separate power supply unit
Fit/Fit Plus NEW
FX-433N
Weight: 1.1kg (including body)
Dimensions H: 40 L: 257
Wireless module included
Dimming rate: 1-100%

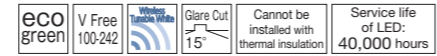

Tunable Fixed Downlight

75 ● 1400TYPE



Cone: Aluminum (mirror matt finish)

LED module included
Frame: Die-cast aluminum (W: matt white / B: matt black)
Driver sold separately
Cannot be installed with thermal insulation
LED module cannot be replaced

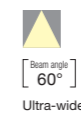

6500K-2700K CRI85

ERD8468W (white)
ERD8468B (black)
Power consumption
14.8W [100-242V]
Rated luminous flux 1336lm
14.8W 90.2lm/W
*At 5000K

Sold separately
Dedicated separate power supply unit
Fit/Fit Plus NEW
FX-432N
Weight: 0.9kg (including body)
Dimensions H: 38 L: 225
Wireless module included
Dimming rate: 1-100%

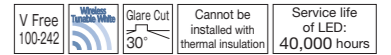

Cone: Aluminum (W: matt white / B: black)

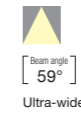

6500K-2700K CRI85

ERD8469W (white)
ERD8469B (black)
Power consumption
14.8W [100-242V]
Rated luminous flux 1271lm
14.8W 85.8lm/W
*At 5000K

* Cannot be installed if there is an obstacle within 150 mm from the ceiling surface.

Tunable Fixed Downlight

75 ● 900TYPE



Cone: Aluminum (mirror matt finish)

LED module included
Frame: Die-cast aluminum (W: matt white / B: matt black)
Driver sold separately
Cannot be installed with thermal insulation
LED module cannot be replaced

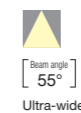

6500K-2700K CRI85

ERD7591W (white)
ERD7591B (black)
Power consumption
10.1W [100-242V]
Rated luminous flux 731lm
10.1W 72.3lm/W
*At 5000K

Sold separately
Dedicated separate power supply unit
Fit/Fit Plus NEW
FX-432N
Weight: 0.7kg (including body)
Dimensions H: 38 L: 225
Wireless module included
Dimming rate: 1-100%

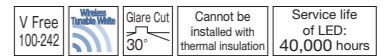

Cone: Aluminum (W: matt white / B: black)

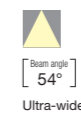

6500K-2700K CRI85

ERD7592W (white)
ERD7592B (black)
Power consumption
10.1W [100-242V]
Rated luminous flux 702lm
10.1W 69.5lm/W
*At 5000K

* Cannot be installed if there is an obstacle within 150 mm from the ceiling surface.

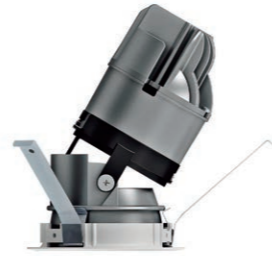

Tunable Adjustable Downlight

75 ● 1400TYPE

V Free 100-242	Wireless Tunable White	Glare Cut 30°	35°	360°	Cannot be installed with thermal insulation	Service life of LED: 40,000 hours	Patent Pending
----------------	------------------------	---------------	-----	------	---	-----------------------------------	----------------



LED module included
 Frame: Die-cast aluminum (W: matt white / B: matt black)
 Cone: Aluminum (matt mirror finish)
 Driver sold separately
 Cannot be installed with thermal insulation
 LED module cannot be replaced

6500K-2700K CRI85

Sold separately
 Dedicated separate power supply unit

Fit/Fit PLUS NEW
 FX-432N

Dimensions H: 38 L: 225
 Wireless module included
 Dimming rate: 1-100%

* Cannot be installed if there is an obstacle within 150 mm from the ceiling surface.

ERD8470W (white)
 ERD8470B (black)
 Power consumption
 14.8W [100-242V]

ERD8471W (white)
 ERD8471B (black)
 Rated luminous flux 1398lm
 14.8W 94.4lm/W

ERD8472W (white)
 ERD8472B (black)
 Rated luminous flux 1336lm
 14.8W 90.2lm/W

* All of the above are at 5000K.

Tunable Adjustable Downlight

75 ● 900TYPE

V Free 100-242	Wireless Tunable White	Glare Cut 30°	35°	360°	Cannot be installed with thermal insulation	Service life of LED: 40,000 hours	Patent Pending
----------------	------------------------	---------------	-----	------	---	-----------------------------------	----------------



LED module included
 Frame: Die-cast aluminum (W: matt white / B: matt black)
 Cone: Aluminum (matt mirror finish)
 Driver sold separately
 Cannot be installed with thermal insulation
 LED module cannot be replaced

6500K-2700K CRI85

Sold separately
 Dedicated separate power supply unit

Fit/Fit PLUS NEW
 FX-432N

Weight: 0.7kg (including body)
 Dimensions H: 38 L: 225
 Wireless module included
 Dimming rate: 1-100%

* Cannot be installed if there is an obstacle within 150 mm from the ceiling surface.

ERD7596W (white)
 ERD7596B (black)
 Power consumption
 10.1W [100-242V]

ERD7597W (white)
 ERD7597B (black)
 Rated luminous flux 879lm
 10.1W 87.0lm/W

ERD7598W (white)
 ERD7598B (black)
 Rated luminous flux 731lm
 10.1W 72.3lm/W

* All of the above are at 5000K.

Tunable Adjustable Downlight

75 ● 1400TYPE

V Free 100-242	Wireless Tunable White	Glare Cut 30°	35°	360°	Cannot be installed with thermal insulation	Service life of LED: 40,000 hours	Patent Pending
----------------	------------------------	---------------	-----	------	---	-----------------------------------	----------------



LED module included
 Frame: Die-cast aluminum (W: matt white / B: matt black)
 Cone: Aluminum (W: matt white / B: black)
 Driver sold separately
 Cannot be installed with thermal insulation
 LED module cannot be replaced

6500K-2700K CRI85

Sold separately
 Dedicated separate power supply unit

Fit/Fit PLUS NEW
 FX-432N

Dimensions H: 38 L: 225
 Wireless module included
 Dimming rate: 1-100%

* Cannot be installed if there is an obstacle within 150 mm from the ceiling surface.

ERD8473W (white)
 ERD8473B (black)
 Power consumption
 14.8W [100-242V]

ERD8474W (white)
 Rated luminous flux 1348lm
 14.8W 91.0lm/W

ERD8474B (black)
 Rated luminous flux 1261lm
 14.8W 85.2lm/W

ERD8475W (white)
 Rated luminous flux 1271lm
 14.8W 85.8lm/W

ERD8475B (black)
 Rated luminous flux 1130lm
 14.8W 76.3lm/W

* All of the above are at 5000K.

Tunable Adjustable Downlight

75 ● 900TYPE

V Free 100-242	Wireless Tunable White	Glare Cut 30°	35°	360°	Cannot be installed with thermal insulation	Service life of LED: 40,000 hours	Patent Pending
----------------	------------------------	---------------	-----	------	---	-----------------------------------	----------------



LED module included
 Frame: Die-cast aluminum (W: matt white / B: matt black)
 Cone: Aluminum (W: matt white / B: black)
 Driver sold separately
 Cannot be installed with thermal insulation
 LED module cannot be replaced

6500K-2700K CRI85

Sold separately
 Dedicated separate power supply unit

Fit/Fit PLUS NEW
 FX-432N

Weight: 0.7kg (including body)
 Dimensions H: 38 L: 225
 Wireless module included
 Dimming rate: 1-100%

* Cannot be installed if there is an obstacle within 150 mm from the ceiling surface.

ERD7599W (white)
 ERD7599B (black)
 Power consumption
 10.1W [100-242V]

ERD7600W (white)
 Rated luminous flux 867lm
 10.1W 85.8lm/W

ERD7600B (black)
 Rated luminous flux 825lm
 10.1W 81.6lm/W

ERD7601W (white)
 Rated luminous flux 702lm
 10.1W 69.5lm/W

ERD7601B (black)
 Rated luminous flux 633lm
 10.1W 62.6lm/W

* All of the above are at 5000K.

An adjustable downlight that accommodates a variety of Tunable White bulbs for applications ranging from spacious interiors to pinpoint product presentations



Precise Tunable White lighting that emphasizes zones or products

Thanks to our pinpoint Tunable White bulbs, this fixture is ideal for emphasizing individual objects. By illuminating an object with a slightly higher color temperature than is used in the surrounding area, the target becomes more prominent, increasing its visibility from a distance. This fixture is recommended for temporary situations, such as events and sales promotions.



Without Tunable White bulbs: 3500K everywhere



With Tunable White bulbs: The visual presentation alone is 4000K.

100 ● 3000TYPE

V Free 100-242	Wireless Tunable White	40°	355°	Cannot be installed with thermal insulation	Service life of LED: 40,000 hours	Patented
----------------	------------------------	-----	------	---	-----------------------------------	----------



LED module included
 Frame: Die-cast aluminum (W: matt white / B: matt black)
 Cone: Die-cast aluminum (W: matt white / B: matt black)
 Driver sold separately
 Cannot be installed with thermal insulation
 LED module cannot be replaced

6500K-2700K CRI85

Sold separately
 Dedicated separate power supply unit

Fit/Fit PLUS NEW
 FX-433N

Weight: 1.1kg (including body)
 Dimensions H: 40 L: 257
 Wireless module included
 Dimming rate: 1-100%

ERD7593W (white)
 ERD7593B (black)
 Power consumption
 27.5W [100-242V]

ERD7594W (white)
 ERD7594B (black)
 Rated luminous flux 2879lm
 27.5W 104.6lm/W

ERD7594W (white)
 ERD7594B (black)
 Rated luminous flux 2924lm
 27.5W 106.3lm/W

ERD7595W (white)
 ERD7595B (black)
 Rated luminous flux 2356lm
 27.5W 85.6lm/W

Tunable LEDZ

Fit Fit Plus Wireless Tunable White Linear 32

A line of Tunable White lighting units for a wide range of uses such as indirect lighting and fixed lighting



Indirect lighting recreates the sky by creating a sense of time and seasonality.

Indirect lighting on and near the ceiling is always easily visible and is a technique that emphasizes the effects of Tunable White lighting. By changing the color temperature over time according to changes in the ambient light, it is possible to obtain a stunning effect resembling the natural light of the sky. This provides customers with a relaxed sense of openness that follows the time of day.



Morning scene: 5000K

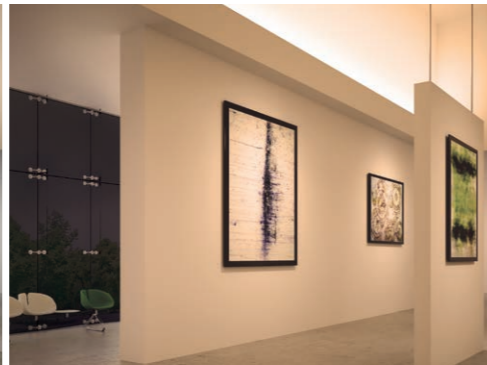

Evening scene: 2700K

L: 1200type 4000
2842lm Tunable

eco green Indoor V Free 100-242 Integrated Driver Service life of LED: 40,000 hours CR 82 Patent Pending

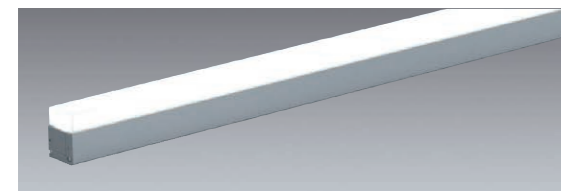

Body: Aluminum (alumite finish)
LED module unit sold separately
Input voltage: 100-242 V
Feeding connector sold separately: RK-581N/566N
Wireless module included

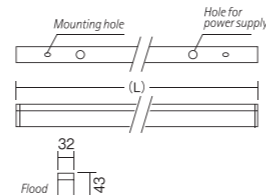

Unit model number / Rated luminous flux / Specific energy consumption efficiency

Light distribution	Type	Fixture length (L) Model number	6500K-2700K		CRI82	
			Unit	Rated luminous flux	Specific energy consumption efficiency	Dimming rate
Diffusion type [139° × 110°]	Tunable White lighting	L: 1500TYPE (L: 1500mm) ERK9864S	Unit NEW FAD-814X	3551lm	135.5lm/W	Dimming rate: 1-100%
		L: 1200TYPE (L: 1200mm) ERK9708S	Unit NEW FAD-815X	2842lm	135.9lm/W	Dimming rate: 1-100%
		L: 900TYPE (L: 900mm) ERK9709S	Unit NEW FAD-816X	2080lm	134.1lm/W	Dimming rate: 1-100%
		L: 600TYPE (L: 600mm) ERK9710S	Unit NEW FAD-817X	1447lm	130.3lm/W	Dimming rate: 1-100%

OPTION

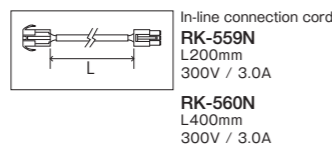

Tunable LEDZ

Linear 32 PWM Type

The Tunable White model controls color and brightness.

The Comfort Tunable White model changes the color automatically in conjunction with a Tunable White bulb.



Flexible control of color and brightness is ideal for creating atmosphere.

By adjusting the color temperature in response to the natural exterior light and modifying the brightness according to the color temperature, you can create a comfortable lighting environment. In addition, the color temperature and illuminance can be increased in the morning and reduced in the evening. As a result, you can follow the rhythm of the day to suit the purpose of the space.

Example of brightness (illuminance) and color temperature settings changing with the time of day

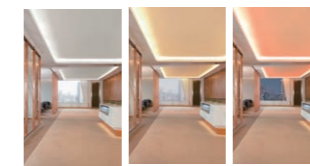
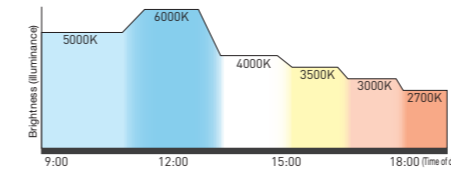

Correlation between color temperature and dimming rate / brightness

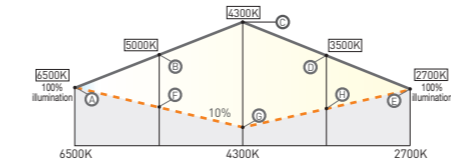

	At 100% illumination (Maximum)	At minimum illumination (Minimum)
6500K (A)	1602lm	-
5000K (B)	2206lm	250lm
4300K (C)	2807lm	188lm
3500K (D)	2102lm	240lm
2700K (E)	1368lm	-

Note: With RAD-855X

L: 1500type 4000 2807lm Tunable
L: 1200type 4000 2532lm Comfort Tunable

Automatic change of color when used with Tunable White bulbs

The color temperature changes automatically from 3000K to 2000K when used with Tunable White bulbs. This produces a natural, warm and relaxing atmosphere similar to that created by an incandescent lamp.

Correlation between dimming rate and brightness / color temperature

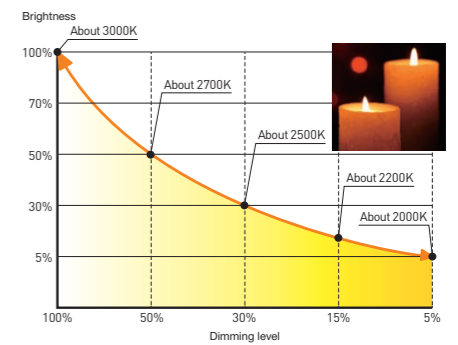

Indoor V Free 100-242 Integrated Driver PWM Service life of LED: 40,000 hours CR 82 Patent Pending

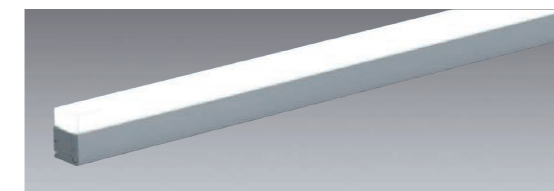

Body: Aluminum (alumite finish)
LED module unit sold separately
Input voltage: 100-242 V
Feeding connector sold separately: RK-581N/566N

Light distribution	Type	Fixture length (L) Model number	6500K-2700K		CRI82	
			Unit	Rated luminous flux	Specific energy consumption efficiency	Dimming rate
Diffusion type [139° × 110°]	Tunable White (PWM Dimming)	L: 1500TYPE (L: 1500mm) ERK9864S	Unit NEW RAD-855X	2807lm	121.5lm/W	Dimming rate: 5-100%
		L: 750TYPE (L: 750mm) ERK9865S	Unit NEW RAD-856X	1533lm	99.5lm/W	Dimming rate: 5-100%
Diffusion type [139° × 110°]	Comfort Tunable White (PWM Dimming)	L: 1200TYPE (L: 1200mm) ERK9708S	Unit RAD-697XA	2532lm	132.5lm/W	Dimming rate: 5-100%
		L: 900TYPE (L: 900mm) ERK9709S	Unit RAD-698XA	2265lm	133.2lm/W	Dimming rate: 5-100%
		L: 600TYPE (L: 600mm) ERK9710S	Unit RAD-699XA	1451lm	126.1lm/W	Dimming rate: 5-100%
		L: 600TYPE (L: 600mm) ERK9710S	Unit RAD-699XA	1451lm	126.1lm/W	Dimming rate: 5-100%

OPTION

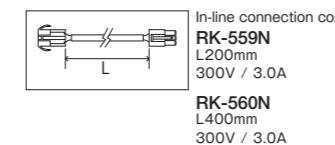
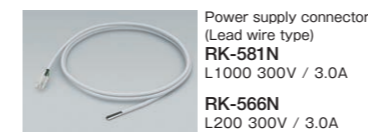

Tunable LEDZ

Fit/Fit Plus Wireless Tunable White Linear T5



Slimmer than a conventional fluorescent light fixture with a T5 tube. Seamless lighting that is easy to use for both indirect lighting and fixture lighting.

A compact fixture providing beautiful indirect light that does not create shadows

Thanks to the use of butt connections, the light emitted through the side cover provides beautiful, shadow-free indirect illumination. The built-in power supply avoids the need for power supply installation space. As a result, the fixture provides beautiful indirect light even when used in the confined spaces of furniture and built-ins.

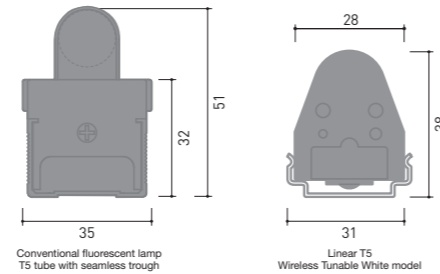
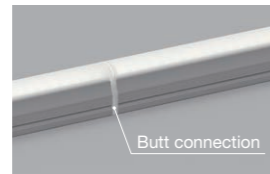

L:1200type
1525lm Tunable

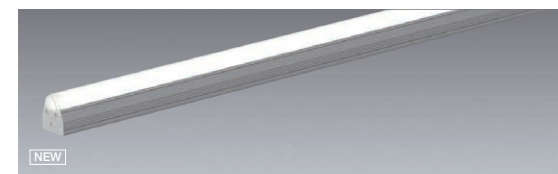

Body: Aluminum (alumite finish) and polycarbonate (milky white)
Mounting clips included
Input voltage: 100-242V
Wireless module included
LED module cannot be replaced
Feeding connector sold separately: RK-581N/566N

Model number / Rated luminous flux / Specific energy consumption efficiency

6500K-2700K CRI82

Tunable White lighting	Light distribution	Type	Fixture length (L)	Model number	Rated luminous flux (lm)	Specific energy consumption efficiency (lm/W)	Module length (mm)	Module power (W)	Weight (kg)
Fit/Fit Plus Wireless Tunable White	Diffusion type	L:1200TYPE (L:1200mm)	1525mm	ERX9679N	132.6	132.6	9990	40.9	1.0
		L:900TYPE (L:900mm)	1206mm	ERX9680N	124.3	124.3	9990	21.7	0.5
		L:600TYPE (L:600mm)	776mm	ERX9681N	115.8	115.8	9990	13.2	0.3

OPTION

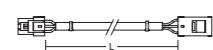

In-line connection cord
RK-559N L200mm 300V / 3.0A
RK-560N L400mm 300V / 3.0A

Tunable LEDZ

Fit/Fit Plus Wireless Tunable White High-powered Flexible Tape Light (for indoor and outdoor use)

A compact, high-powered, all-purpose tape light for indoor and outdoor use. Can be ordered in lengths of 30-mm increments.

Highly waterproof construction resistant to a wide range of temperatures. Safe for use both indoors and outdoors.

With an IP65 enclosure rating, this waterproof design can withstand moisture and rain. Thanks to its robust structure, it can be used outdoors even in cold environments or in sunlight in high temperatures.

Notes
• Mount in a well-drained location.
• The service life of the light source is compliant with JIS C8155:2010/Luminous flux maintenance rate: 70% minimum

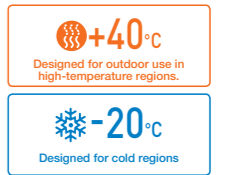

L:1000type
500lm Tunable



Body: Resin (transparent)
Input voltage: 24 VDC
Driver sold separately
Power connection cable included
End cap included
LED module cannot be replaced
Moistureproof and rainproof
Select a suitable power supply unit accordingly on the fixture length to be connected

Tunable White lighting	Light distribution	Type	Fixture length (L)	Model number	Rated luminous flux (5000K)	Power consumption	Specific energy consumption efficiency	Module length	Module power	Weight
Fit/Fit Plus Wireless Tunable White	Diffusion type	L:10000TYPE	10012mm	ERX19990DL	4227	48.1	87.8	9990	40.9	1.0
		L:5000TYPE	5002mm	ERX14980DL	2217	26.5	83.6	4980	21.7	0.5
		L:3000TYPE	2992mm	ERX12970DL	1352	18.1	74.6	2970	13.2	0.3
		L:2000TYPE	2002mm	ERX11980DL	913	13.6	67.1	1980	9.0	
		L:1500TYPE	1492mm	ERX11470DL	684	11.0	62.1	1470	6.7	0.2
		L:1250TYPE	1252mm	ERX11230DL	575	9.7	59.2	1230	5.7	
		L:1000TYPE	1012mm	ERX10990DL	466	8.3	56.1	990	4.6	
		L:750TYPE	742mm	ERX10720DL	344	6.5	52.9	720	3.4	0.1
		L:500TYPE	502mm	ERX10480DL	234	4.9	47.7	480	2.3	
		L:300TYPE	322mm	ERX10300DL	151	3.5	43.1	300	1.5	

Number of separate connected power supply units (sold separately)

Dedicated separate power supply unit	Tunable White lighting	Fit Color tuning driver circuit	Dimming rate	Power supply size	Power input	Rated output	Primary side	Secondary side	Maximum number of connected units			
									Maximum module power		Module power minimum	Total wiring length
									Total when connected in series	Total when connected in parallel		
RX-406N	Tunable White lighting (Wireless Tunable White)	NEW FX-437N	1-100%	L200xH49xW63	100-200 VAC	24 VDC 2.5A 60W	Lead Wire L: 140 mm	Lead Wire L: 140 mm	42W	48W	3W	4 m max.
RX-405N	Tunable White lighting (Wireless Tunable White)	NEW FX-437N	1-100%	L219xH49xW63	100-200 VAC	24 VDC 3.75A 90W	Lead Wire L: 140 mm	Lead Wire L: 140 mm	42W	72W	5W	4 m max.
RX-404N	Tunable White lighting (Wireless Tunable White)	NEW FX-437N	1-100%	L239xH49xW63	100-200 VAC	24 VDC 6.25A 150W	Lead Wire L: 140 mm	Lead Wire L: 140 mm	42W	120W	7W	4 m max.

Notes • For details on the maximum cable length on the secondary side of the power supply, refer to the specification drawings.
• Total wiring length excludes connectors. • When installing this unit outdoors, perform waterproofing treatment on the fixture as indicated in the instruction manual.

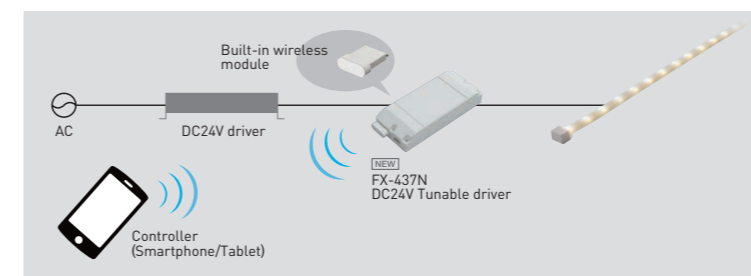

OPTION

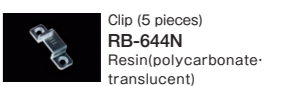

DC24V Tunable driver
FX-437N
Input: DC24V
Output current: 6.25A
Maximum connection power capacity: 150W
Weight: 0.1 kg

Tunable LEDZ



Tunable Linear Light Tunable White Linear 50/Linear 32



Flexible control of color and brightness is ideal for creating atmosphere.

By adjusting the color temperature in response to the natural exterior light and modifying the brightness according to the color temperature, you can create a comfortable lighting environment. In addition, the color temperature and illuminance can be increased in the morning and reduced in the evening. As a result, you can follow the rhythm of the day to suit the purpose of the space.

Example of brightness (illuminance) and color temperature settings changing with the time of day

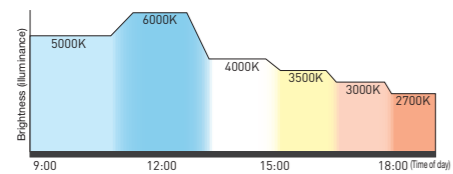

Tunable Luminous Flux Ratios

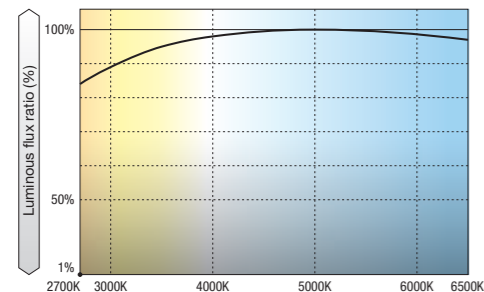

Notes:
 • At a color temperature of 5000K, the change in luminous flux due to tuning is indexed as 100%.
 • The ratio curve depicted above represents typical values. Some variation occurs depending on the fixtures used and the dimming level setting.
 • Due to the characteristics of LEDs, variations in light color may increase at dimming rates of 10% or less.

■ Surface-mounted/Pendant type ▶ p. 37

Lighting system with 3-way connections

This flexible lighting system adopts the unit method. Choose either upper and lower light distribution or lower light distribution alone. It can be used as a 3-way fixture configured as a surface-mounted or pendant installation.



Creating healthy office spaces with Tunable White lighting

The lighting environment in the office, where we spend much of our day, can have a huge impact on our health. Tunable White lighting helps to reduce the contrast between indoor lighting and natural outdoor light, which contributes to the maintenance of healthy biorhythms. This promotes good sleep and helps to create environments that support the health of office workers.

Certification to the WELL Building Standard

WELL certification is a building certification system. Operated by the International WELL Building Institute (IWBI) of the U.S.A., it is intended to evaluate healthy and productive spaces. It consists of a list of evaluation items based on eight concepts: air, water, nourishment, light, fitness, comfort, mind, and innovation. Under the category of lighting, "circadian lighting design" and "electric light glare control" are essential factors in the certification matrix.

As seen in this example, initiatives to design environments focused on the health of workers are accelerating worldwide.

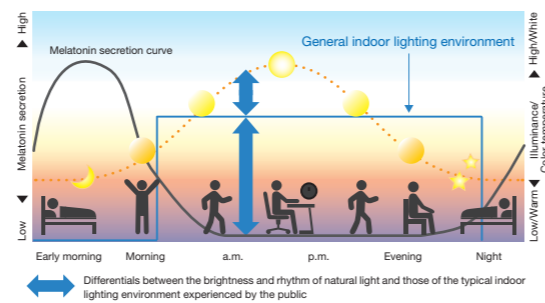

In contemporary indoor lighting environments in which the color temperature and brightness levels remain constant, a measurable difference arises between natural ambient light and indoor lighting as time passes. This is believed to affect the secretion of melatonin. When melatonin production is suppressed, some people have difficulty sleeping. By closely reproducing the natural rhythm of light with Tunable White light-quality LEDs, one can increase or decrease the secretion of melatonin, thereby contributing to a setting conducive to either a more alert or more relaxed state of mind.

Linear 50

Surface mounted Surface-mounted type W50×H56×L1250	Recessed Recessed type Cut out size (for a single unit) 65×1260	Surface mounted Bracket type (up and down light distribution) W60×H80×L1257
eco green V Free 100-242 Service life of LED: 40,000 hours Patent Pending CR 82	eco green V Free 100-242 Service life of LED: 40,000 hours Patent Pending CR 82	V Free 100-242 Service life of LED: 40,000 hours Patent Pending CR 82
ERK9940W (Fixture)	ERK9944W (Body: Single unit) ERK9945W (Body: Connection unit) ERK9946W (Body: End unit)	ERK9995W (Body: For single/connecting use)
L:1200 TYPE Unit 6500K-2700K NEW FAD-854X Power consumption 45.6W (100-242V)	Rated luminous flux / Specific energy consumption efficiency 6337 lm 138.9 lm/W Weight: 1.6kg	Rated luminous flux / Specific energy consumption efficiency 6276 lm 137.6 lm/W Weight: 1.9kg

Linear 50

Recessed Slit type Cut out size (for a single unit) 65×1260	Recessed Recessed open type Cut out size (for a single unit) 85×1260	Recessed Recessed open deep type Cut out size (for a single unit) 110×1260
V Free 100-242 Service life of LED: 40,000 hours Patent Pending CR 82	V Free 100-242 Service life of LED: 40,000 hours Patent Pending CR 82	V Free 100-242 Service life of LED: 40,000 hours Patent Pending CR 82
ERK1007W (Body: Single unit) ERK1008W (Body: Connection unit) ERK1009W (Body: End unit)	ERK1015W (Body: Single unit) ERK1016W (Body: Connection unit) ERK1017W (Body: End unit)	ERK1031W (Body: Single unit) ERK1032W (Body: Connection unit) ERK1033W (Body: End unit)
L:1200 TYPE Unit 6500K-2700K NEW FAD-854X Power consumption 45.6W (100-242V)	Rated luminous flux / Specific energy consumption efficiency 5208 lm 114.2 lm/W Weight: 2.7kg	Rated luminous flux / Specific energy consumption efficiency 4981 lm 109.2 lm/W Weight: 2.1kg

Linear 50

Surface mounted Pendant type W58×H65×L1504	Surface mounted Surface mounted slit type W58×H65×L1504	Surface mounted Surface-mounted type W70×H105×L1255
V Free 100-242 Service life of LED: 40,000 hours Patent Pending CR 82	V Free 100-242 Service life of LED: 40,000 hours Patent Pending CR 82	V Free 100-242 Service life of LED: 40,000 hours Patent Pending CR 82
ERK9947W (Body: Single unit) ERK9948W (Body: Connection unit) ERK9949W (Body: End unit)	ERK9947W (Body: Single unit) ERK9948W (Body: Connection unit) ERK9949W (Body: End unit)	ERK9992W (Body: For single/connecting use)
L:1200 TYPE Unit 6500K-2700K NEW FAD-854X Power consumption 45.6W (100-242V)	Rated luminous flux / Specific energy consumption efficiency 5224 lm 114.5 lm/W Weight: 2.6kg	Rated luminous flux / Specific energy consumption efficiency 5224 lm 114.5 lm/W Weight: 2.6kg

OPTION (Only for Pendant type)

Recessed type	Suspension bracket RK-541W Matt white · Wire	In-line connection cord RK-559N L200mm 300V / 3.0A
	Suspension bracket (Power supply parts included) RK-592W Wiring cord included Matt white · Wire	RK-560N L400mm 300V / 3.0A

Linear 32 / Linear 50

Surface mounted Pendant type

W70×H105×L1255

V Free 100-242 Service life of LED: 40,000 hours Patent Pending **CR 82**

ERK9992W (Fixture: For use as single unit or linked unit)

L:1200 TYPE

Linear 32, upper light distribution unit (L:900TYPE)
Linear 50, lower light distribution unit (L:1200TYPE)

Tunable White lighting Unit **6500K-2700K**

Light distribution	Unit	Rated luminous flux / Specific energy consumption efficiency
Upper and lower light distribution	FAD-816X Power consumption 15.5W (100-242V)	When the units are combining 7128 lm 114.7 lm/W Power consumption 61.1W Weight: 4.9kg
Lower light distribution only	FAD-854X Power consumption 45.6W (100-242V)	5366 lm 117.6 lm/W Weight: 4.4kg

Linear 32

Surface mounted Pendant type

W55×H105×L1204

V Free 100-242 Service life of LED: 40,000 hours Patent Pending **CR 82**

ERK9993W (Body: For single/connecting use)

L:1200 TYPE

Linear 32, upper light distribution unit (L:900TYPE)
Linear 32, lower light distribution unit (L:1200TYPE)

Tunable White lighting Unit **6500K-2700K**

Light distribution	Unit	Rated luminous flux / Specific energy consumption efficiency
Upper and lower light distribution	FAD-816X Power consumption 15.5W (100-242V)	When the units are combining 4813 lm 132.9 lm/W Power consumption 36.2W Weight: 4.4kg
Lower light distribution only	FAD-815X Power consumption 20.7W (100-242V)	2407 lm 116.2 lm/W Weight: 3.2kg

OPTION

Recessed type

Suspension bracket **RK-541W**
Matt white -Wire

Suspension bracket (Power supply parts included) **RK-592W**
Wiring cord included
Matt white -Wire

In-line connection cord **RK-559N**
L200mm
300V / 3.0A

RK-560N
L400mm
300V / 3.0A

Linear 32

Surface mounted Surface-mounted type

W32×H43×L1200

eco green V Free 100-242 Service life of LED: 40,000 hours Patent Pending **CR 82**

ERK9708W (Fixture)

Recessed Recessed type

W32×H43×L1200

eco green V Free 100-242 Service life of LED: 40,000 hours Patent Pending **CR 82**

ERK9712W (Body: Single unit)
ERK9713W (Body: Connection unit)
ERK9714W (Body: End unit)

Recessed Slit type

W32×H43×L1200

eco green V Free 100-242 Service life of LED: 40,000 hours Patent Pending **CR 82**

ERK1011W (Body: Single unit)
ERK1012W (Body: Connection unit)
ERK1013W (Body: End unit)

L:1200 TYPE

Tunable White lighting Unit **6500K-2700K**

Light distribution	Unit	Rated luminous flux / Specific energy consumption efficiency
Surface-mounted type	FAD-815X Power consumption 20.7W (100-242V)	2814 lm 135.9 lm/W Weight: 0.9kg
Recessed type	ERK9712W (Body: Single unit) ERK9713W (Body: Connection unit) ERK9714W (Body: End unit)	2814 lm 135.9 lm/W Weight: 1.3kg
Recessed slit type	ERK1011W (Body: Single unit) ERK1012W (Body: Connection unit) ERK1013W (Body: End unit)	2336 lm 112.8 lm/W Weight: 1.8kg

Linear 32

Surface mounted Surface-mounted type

W32×H43×L600

eco green V Free 100-242 Service life of LED: 40,000 hours Patent Pending **CR 82**

ERK9710W (Fixture)

Recessed Recessed type

W32×H43×L600

eco green V Free 100-242 Service life of LED: 40,000 hours Patent Pending **CR 82**

ERK9715W (Body: End unit)

Recessed Slit type

W32×H43×L600

eco green V Free 100-242 Service life of LED: 40,000 hours Patent Pending **CR 82**

ERK1014W (Body: End unit)

L:600 TYPE

Tunable White lighting Unit **6500K-2700K**

Light distribution	Unit	Rated luminous flux / Specific energy consumption efficiency
Surface-mounted type	FAD-817X Power consumption 11.1W (100-242V)	1447 lm 130.3 lm/W Weight: 0.6kg
Recessed type	ERK9715W (Body: End unit)	1433 lm 129.0 lm/W Weight: 0.8kg
Recessed slit type	ERK1014W (Body: End unit)	1189 lm 107.1 lm/W Weight: 1.1kg

OPTION

Power supply connector (Lead wire type) **RK-581N**
L1000 300V / 3.0A

RK-566N
L200 300V / 3.0A

In-line connection cord **RK-559N**
L200mm
300V / 3.0A

Linear 32

Recessed Recessed open type

W55×H105×L1204

eco green V Free 100-242 Service life of LED: 40,000 hours Patent Pending **CR 82**

ERK1019W (Body: Single unit)
ERK1020W (Body: Connection unit)
ERK1021W (Body: End unit)

Surface mounted Wall washer

W70×H95×L1204

eco green V Free 100-242 Service life of LED: 40,000 hours Patent Pending **CR 82**

ERK9937W (Fixture)

Surface mounted Surface-mounted type

W55×H105×L1204

eco green V Free 100-242 Service life of LED: 40,000 hours Patent Pending **CR 82**

ERK9993W (Body: For single/connecting use)

L:1200 TYPE

Tunable White lighting Unit **6500K-2700K**

Light distribution	Unit	Rated luminous flux / Specific energy consumption efficiency
Recessed open type	FAD-815X Power consumption 20.7W (100-242V)	2234 lm 107.9 lm/W Weight: 1.5kg
Wall washer	ERK9937W (Fixture)	2335 lm 112.8 lm/W Weight: 2.0kg
Surface-mounted type	ERK9993W (Body: For single/connecting use)	2407 lm 116.2 lm/W Weight: 3.2kg

Recessed Recessed open type

W55×H105×L1204

eco green V Free 100-242 Service life of LED: 40,000 hours Patent Pending **CR 82**

ERK1022W (Body: End unit)

L:600 TYPE

Tunable White lighting Unit **6500K-2700K**

Light distribution	Unit	Rated luminous flux / Specific energy consumption efficiency
Recessed open type	FAD-817X Power consumption 11.1W (100-242V)	1137 lm 102.4 lm/W Weight: 1.0kg

Linear 32

Surface mounted Bracket type (Upper light distribution)

D60×H80

W: White
U: Dark brown

Body: Aluminum (W: Matt white / U: Dark brown)
LED Module Unit sold separately
For both single and connecting use
Feeding connector sold separately: RK-581N/566N
End cap included

Indoor V Free 100-242 Integrated Driver Service life of LED: 40,000 hours **CR 82**

Tunable White lighting	Length	Body model number	Unit model number		Rated luminous flux / Specific energy consumption efficiency	Remarks
			6500K-2700K	CR182		
FIT-FIT Plus	L:2400TYPE	ERK9956W (white) ERK9956U (dark brown)	Power consumption 41.4W	FAD-815X × 2	5103 lm 123.2 lm/W [9]	Weight: 4.5kg
	L:1500TYPE	ERK9957W (white) ERK9957U (dark brown)	Power consumption 26.2W	FAD-814X × 1	3188 lm 121.6 lm/W [9]	Weight: 3.2kg
	L:1200TYPE	ERK9958W (white) ERK9958U (dark brown)	Power consumption 20.7W	FAD-815X × 1	2551 lm 123.2 lm/W [9]	Weight: 2.6kg
	L:900TYPE	ERK9959W (white) ERK9959U (dark brown)	Power consumption 15.5W	FAD-816X × 1	1867 lm 120.4 lm/W [9]	Weight: 2.1kg
	L:600TYPE	ERK9961W (white) ERK9961U (dark brown)	Power consumption 11.1W	FAD-817X × 1	1299 lm 117.0 lm/W	Weight: 1.5kg
	PWM Dimming	L:1500TYPE	ERK9957W (white) ERK9957U (dark brown)	Power consumption 23.1W	RAD-855X × 1	2520 lm 109.0 lm/W
L:750TYPE		ERK9960W (white) ERK9960U (dark brown)	Power consumption 15.4W	RAD-856X × 1	1376 lm 89.3 lm/W	Weight: 1.9kg

OPTION

Power supply connector (Lead wire type) **RK-581N**
L1000 300V / 3.0A

RK-566N
L200 300V / 3.0A

In-line connection cord **RK-559N**
L200mm
300V / 3.0A

Tunable LEDZ

Fit/Fit Plus Wireless Tunable White Tunable Square Panel Light

A low-profile fixed light ideal for offices, conference rooms and stores



Typical Tunable White Settings



5000K 100% brightness

Start of the day
Welcoming with a bright light similar to sunrise

The illuminance inside the store is set high during periods of strong outdoor light so that the store interior does not feel dark in comparison.

4000K 90% brightness

When it is bright outside
A refreshingly bright interior is welcoming.

Ensures good visibility in crowded stores and promotes the customers' willingness to purchase.

3000K 80% brightness

Evening hours
Creates a homey atmosphere by gradually lowering the color temperature from the morning to the noon hour.

At the same time, fresh foods and prepared foods are well illuminated to convey a sense of freshness.

Comparison of morning and noon 40% reduction

The color temperature and brightness are reduced during evening and night-time hours to create a calming space and further reduce power consumption.

2700K 60% brightness

Night-time setting
The side dish counter and alcohol counter are busy.

The side dishes create an impression of freshness while the overall brightness is kept low.

600 Series

Recessed White acrylic panel



eco green V Free 100-242 Integrated Driver Wireless Tunable White Service life of LED: 40,000 hours CR 82

11000lm TYPE

6500K-2700K
EFK1028W Power consumption 87.4W
12398 lm 141.8 lm/W

Surface mounted White acrylic panel



eco green V Free 100-242 Integrated Driver Wireless Tunable White Service life of LED: 40,000 hours CR 82

11000lm TYPE

6500K-2700K
EFK1027W Power consumption 87.4W
12398 lm 141.8 lm/W

450 Series

Recessed White acrylic panel



eco green V Free 100-242 Integrated Driver Wireless Tunable White Service life of LED: 40,000 hours CR 82

6000lm TYPE

6500K-2700K
EFK1030W Power consumption 37.3W
5256 lm 140.9 lm/W

Surface mounted White acrylic panel



eco green V Free 100-242 Integrated Driver Wireless Tunable White Service life of LED: 40,000 hours CR 82

6000lm TYPE

6500K-2700K
EFK1029W Power consumption 37.3W
5256 lm 140.9 lm/W

275 Series

Recessed White acrylic panel



V Free 100-242 Integrated Driver Wireless Tunable White Service life of LED: 40,000 hours CR 82

2700lm TYPE

6500K-2700K
EFK9994W Power consumption 23.1W
2727 lm 118.0 lm/W

Tunable LEDZ

Fit/Fit Plus Wireless Tunable White Tunable Base Light

An extensive product line with easy pricing



4 Feet

eco green	V Free 100-242	Service life of LED: 40,000 hours	CR 82	Unit
				6500K-2700K
Tunable White lighting				
FIT/FIT PLUS				
NEW				
6900lm TYPE				
Power consumption 45.6W (100-242V)				
				FAD-827X
NEW				
5200lm TYPE				
Power consumption 35.0W (100-242V)				
				FAD-828X

4 Feet

eco green	V Free 100-242	Service life of LED: 40,000 hours	CR 82	Unit
				6500K-2700K
Tunable White lighting				
FIT/FIT PLUS				
NEW				
6900lm TYPE				
Power consumption 45.6W (100-242V)				
				FAD-827X
NEW				
5200lm TYPE				
Power consumption 35.0W (100-242V)				
				FAD-828X

Surface mounted V shape



W:230

ERK9584W (Fixture)
Body: White
Weight: 2.4kg

Rated luminous flux / Specific energy consumption efficiency	
6758 lm	148.2 lm/W
5200 lm	148.5 lm/W

Surface mounted V shape



W:150

ERK9635W (Fixture)
Body: White
Weight: 2.0kg

Rated luminous flux / Specific energy consumption efficiency	
6758 lm	148.2 lm/W
5200 lm	148.5 lm/W

Surface mounted Linear type



W:79

ERK9636W (Fixture)
Body: White
Weight: 1.6kg

Rated luminous flux / Specific energy consumption efficiency	
6846 lm	150.1 lm/W
5268 lm	150.5 lm/W

Surface mounted With reflective shades

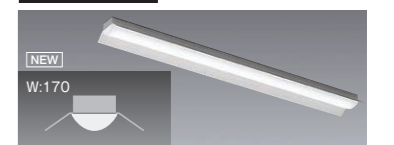

W:170

ERK9820WA (Fixture)
Body: White
Weight: 2.4kg

Rated luminous flux / Specific energy consumption efficiency	
6664 lm	146.1 lm/W
5128 lm	146.5 lm/W

4 Feet

eco green	V Free 100-242	Service life of LED: 40,000 hours	CR 82	Unit 6500K-2700K
NEW	6900 lm TYPE Power consumption 45.6W (100-242V)		FAD-827X	
	5200 lm TYPE Power consumption 35.0W (100-242V)		FAD-828X	

4 Feet

eco green	V Free 100-242	Service life of LED: 40,000 hours	CR 82	Unit 6500K-2700K
NEW	6900 lm TYPE Power consumption 45.6W (100-242V)		FAD-829X	
	5200 lm TYPE Power consumption 35.0W (100-242V)		FAD-830X	

4 Feet

eco green	V Free 100-242	Service life of LED: 40,000 hours	CR 82	Unit 6500K-2700K
NEW	6900 lm TYPE Power consumption 45.6W (100-242V)		FAD-829X	
	5200 lm TYPE Power consumption 35.0W (100-242V)		FAD-830X	

4 Feet

eco green	V Free 100-242	Service life of LED: 40,000 hours	CR 82	Unit 6500K-2700K
NEW	6900 lm TYPE Power consumption 45.6W (100-242V)		FAD-829X	
	5200 lm TYPE Power consumption 35.0W (100-242V)		FAD-830X	

Recessed Troffer type

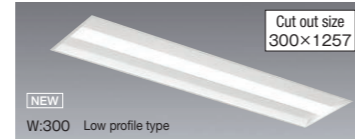

ERK9985W (Fixture)
Body: White Weight: 3.7kg
With connecting brackets
Low profile type

Rated luminous flux / Specific energy consumption efficiency	6662 lm 146.0 lm/W
5127 lm 146.4 lm/W	

Recessed Troffer type

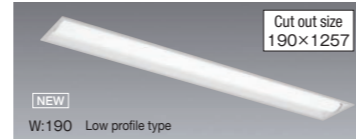

ERK9987W (Fixture)
Body: White Weight: 2.7kg
With connecting brackets
Low profile type

Rated luminous flux / Specific energy consumption efficiency	6655 lm 145.9 lm/W
5121 lm 146.3 lm/W	

Surface mounted Troffer type

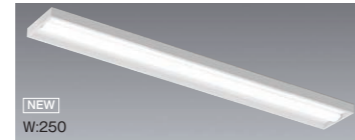

ERK9983W (Fixture)
Body: White Weight: 3.8kg

Rated luminous flux / Specific energy consumption efficiency	6655 lm 145.9 lm/W
5121 lm 146.3 lm/W	

Surface mounted Wall-washer type

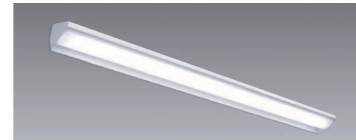

ERK9818W (Fixture)
Body: White Weight: 2.3kg

Rated luminous flux / Specific energy consumption efficiency	6474 lm 141.9 lm/W
4982 lm 142.3 lm/W	

Recessed Troffer type

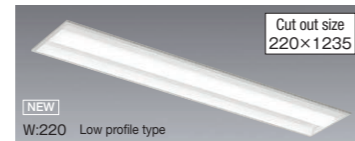

ERK9989W (Fixture)
Body: White Weight: 3.2kg
With connecting brackets
Low profile type

Rated luminous flux / Specific energy consumption efficiency	6655 lm 145.9 lm/W
5121 lm 146.3 lm/W	

Recessed Troffer type

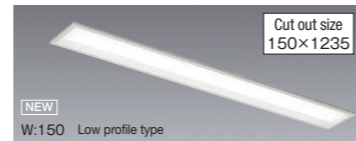

ERK9990W (Fixture)
Body: White Weight: 2.5kg
With connecting brackets
Low profile type

Rated luminous flux / Specific energy consumption efficiency	6633 lm 145.4 lm/W
5104 lm 145.8 lm/W	

Recessed White louver type

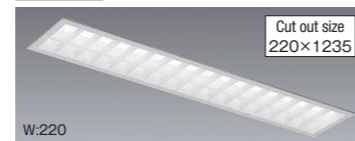

ERK9929W (Fixture)
Body: White Weight: 5.1kg
With connecting brackets

Rated luminous flux / Specific energy consumption efficiency	5630 lm 123.4 lm/W
4333 lm 123.8 lm/W	

Recessed White louver type

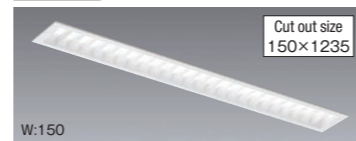

ERK9567WA (Fixture)
Body: White Weight: 4.7kg
With connecting brackets

Rated luminous flux / Specific energy consumption efficiency	5630 lm 123.4 lm/W
4333 lm 123.8 lm/W	

INDEX

MODEL NUMBER	PAGE	MODEL NUMBER	PAGE	MODEL NUMBER	PAGE	MODEL NUMBER	PAGE	MODEL NUMBER	PAGE	MODEL NUMBER	PAGE
EFK		ERD7598B	29	ERD8474B	29	ERK9710S	31-32	ERK9990W	41	FX-433N	24-25-27-30
EFK1027W	39	ERD7598W	29	ERD8474W	29	ERK9710W	37	ERK9992W	36-37	FX-434N	27
EFK1028W	39	ERD7599B	29	ERD8475B	29	ERK9712W	37	ERK9993W	37-38	FX-435N	26
EFK1029W	39	ERD7599W	29	ERD8475W	29	ERK9713W	37	ERK9995W	36	FX-436N	26
EFK1030W	39	ERD7600B	29	ERD8476B	25	ERK9714W	37	ERX		FX-437N	34
EFK9994W	39	ERD7600W	29	ERD8476W	25	ERK9715W	37	ERX10300DL	34	FX-439N	21
EFX		ERD7601B	29	ERD8477B	25	ERK9818W	41	ERX10480DL	34	FX-440B	21
EFX9679N	33	ERD7601W	29	ERD8477W	25	ERK9820WA	40	ERX10720DL	34	FX-440W	21
EFX9680N	33	ERD7602W	24	ERD8478B	24	ERK9864S	31-32	ERX10990DL	34	FX-441B	21
EFX9681N	33	ERD7603B	24	ERD8478W	24	ERK9865S	32	ERX11230DL	34	FX-441W	21
ERD		ERD7603W	24	ERK		ERK9929W	41	ERX11470DL	34	FX-452N	21
ERD7583W	26	ERD7604W	25	ERK1007W	36	ERK9937W	38	ERX11980DL	34	RAD	
ERD7584W	26	ERD7605W	25	ERK1008W	36	ERK9940W	36	ERX12970DL	34	RAD-697XA	32
ERD7585W	26	ERD7606B	25	ERK1009W	36	ERK9944W	36	ERX14980DL	34	RAD-698XA	32
ERD7586W	26	ERD7606W	25	ERK1011W	37	ERK9945W	36	ERX19990DL	34	RAD-699XA	32
ERD7587B	27	ERD7607B	25	ERK1012W	37	ERK9946W	36	FAD		RAD-855X	32-38
ERD7587W	27	ERD7607W	25	ERK1013W	37	ERK9947W	36	FAD-814X	31-38	RAD-856X	32-38
ERD7588W	27	ERD7608B	24	ERK1014W	37	ERK9948W	36	FAD-815X	31-37-38	RB	
ERD7589B	27	ERD7608W	24	ERK1015W	36	ERK9949W	36	FAD-816X	31-37-38	RB-485S	31-32
ERD7589W	27	ERD7609B	25	ERK1016W	36	ERK9956U	38	FAD-817X	31-37-38	RB-643N	34
ERD7590W	27	ERD7609W	25	ERK1017W	36	ERK9956W	38	FAD-827X	40-41	RB-644N	34
ERD7591B	28	ERD7610B	25	ERK1019W	38	ERK9957U	38	FAD-828X	40-41	RK	
ERD7591W	28	ERD7610W	25	ERK1020W	38	ERK9957W	38	FAD-829X	41	RK-541W	36-37
ERD7592B	28	ERD8468B	28	ERK1021W	38	ERK9958U	38	FAD-830X	41	RK-559N	31-32-33-36-37-38
ERD7592W	28	ERD8468W	28	ERK1022W	38	ERK9958W	38	FAD-854X	36-37	RK-560N	31-32-33-36-37
ERD7593B	30	ERD8469B	28	ERK1031W	36	ERK9959U	38	FX		RK-566N	31-32-33-37-38
ERD7593W	30	ERD8469W	28	ERK1032W	36	ERK9959W	38	FX-269B	21	RK-581N	31-32-33-37-38
ERD7594B	30	ERD8470B	29	ERK1033W	36	ERK9960U	38	FX-269W	21	RK-592W	36-37
ERD7594W	30	ERD8470W	29	ERK9567WA	41	ERK9960W	38	FX-304W	21	RX	
ERD7595B	30	ERD8471B	29	ERK9584W	40	ERK9961U	38	FX-426N	21	RX-404N	34
ERD7595W	30	ERD8471W	29	ERK9635W	40	ERK9961W	38	FX-427W	21	RX-405N	34
ERD7596B	29	ERD8472B	29	ERK9636W	40	ERK9983W	41	FX-428B	21	RX-406N	34
ERD7596W	29	ERD8472W	29	ERK9708S	31-32	ERK9985W	41	FX-428W	21		
ERD7597B	29	ERD8473B	29	ERK9708W	37	ERK9987W	41	FX-431W	21		
ERD7597W	29	ERD8473W	29	ERK9709S	31-32	ERK9989W	41	FX-432N	24-25-28-29		

SAFETY QUALITY REPORT

Aiming for further reliability improvement

Durability



ENDO products are subject to a rigorous testing program to rectify any safety issues.

To ascertain the limits of product and part performance and identify in advance any latent defects or weaknesses, we subject energized products to harsh heat and vibration stress several times greater than what is used in conventional reliability testing. Any defects or weaknesses identified as a result of this testing that may harbor safety or functional deficiencies are addressed by design changes or part replacements to ensure safety and functional integrity.



ENDO is the first Japanese lighting manufacturer to introduce Highly Accelerated Life Test (HALT), a type of destructive testing.

HALT tester
HALT testing consists of five steps: (1) a low-temperature stage, (2) a high-temperature stage, (3) a rapid temperature fluctuation stage, (4) a vibration stage, and (5) a compound (thermal shock + vibration) stage. We enhance product reliability by identifying operational and breakdown limits that lie outside the product specifications and optimizing the margins that lie between the specifications and those limits.

(Principal specifications)
- Temperature stress test: Maximum temperature range: -100°C to 200°C
- Vibration stress test: Maximum vibration range: 0 to 70 G

Measure against interference waves



The ENDO products satisfy the engineering criteria of the Electrical Appliances and Materials Safety Act.

From July 1, 2012, LED lighting fixtures are covered by the Electrical Appliances and Materials Safety Act. In ENDO products, not only the products applicable to the Electrical Appliances and Materials Safety Act, but also some non-applicable products (e.g. straight type LED module, etc.) are designed to satisfy the engineering criteria of the Electrical Appliances and Materials Safety Act based on the strict inspection standard of ENDO.

Item	Standard value		Remark
	Frequency range	Limit value	
Noise terminal voltage	526 5kHz~5MHz 5MHz~30MHz	56 dB or less 60 dB or less	In accordance with the Electrical Appliances and Materials Safety Act
Noise power	30MHz~300MHz	55 dB or less	In accordance with the Electrical Appliances and Materials Safety Act

◀ Radio wave test chamber

Noise reliability which satisfies the criteria of the Electrical Appliances and Materials Safety Act

The ENDO products have noise-resistant performance which sufficiently satisfies the noise terminal voltage and the noise power specified in the Electrical Appliances and Materials Safety Act

Noise emitted from electric/electronic devices is controlled by the Electrical Appliances and Materials Safety Act. Lighting fixtures applicable to the Electrical Appliances and Materials Safety Act are required to pass the noise terminal voltage test and the noise power test. Conventional lighting fixtures have not given significant effect on TV or radio. The ENDO products satisfy the criteria of the Electrical Appliances and Materials Safety Act similar to general lighting fixtures. Now, the LED lighting fixtures are added to the items for control as an electric appliance applicable to the Electrical Appliances and Materials Safety Act.

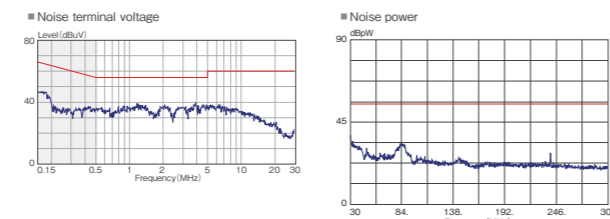

▲ Noise test chamber

◀ Lightning Surge Tester

RoHS directive on restriction of the use of certain hazardous substances

In Europe, the RoHS directive^{*2} which restricts the use of 6 types of specified hazardous substances^{*1} contained in electric/electronic appliances sold in EU member nations is in force. After July, 2006, inclusion of specified hazardous substances is prohibited except for some applications. In the Green Purchasing Act, based on this movement, display and announcement for inclusion of specified hazardous substances are added to "Judgment criteria"^{*3}.

*1 Specified hazardous substances: Lead, mercury, cadmium, hexavalent chromium compound, polybromobiphenyl and polybromodiphenylether
*2 RoHS directive: European Parliament and Council Directive on restriction of the use of specified hazardous substances contained in electric/electronic appliances
*3 The content standard value is in accordance with the table A1, Appendix A and Appendix B in JIS C 0950: 2008.

Waterproof performance

Waterproof test complying with the JIS standard is performed.

Under the conditions specified in the JIS standard, the waterproof test has been performed longer than the time specified to check the waterproof performance of the products.

Standard value of waterproof test

In JIS standard C8105-1, the protection class (IP code) against entry of moisture from outside the product is specified with the specified measurement/testing method. The ENDO products have been through the tests complying with the JIS standard to check the waterproof performance.



Protection class against entry of moisture (JIS standard)

Secondary characteristic number	Protection class	
	Summary	Definition
3 (IPX3)	Protection against spraying water	Water sprayed at the angle from vertical to 60 degrees on both sides must not give adverse effect.

Automated waterproof tester

Waterproof tests specified by IEC and JIS are performed. It is used to check if adverse effect from rain or humidity is given and if safety is ensured by applying intermittent artificial rains over night and day.

Verification for durability, weatherproof



Weather meter



Thermal shock tester

For salt damage district

Salt water spray test
Mist salt water is sprayed to the coating surface and the plated surface to verify the corrosion resistance performance of the paint and the metal surface treatment.



Earthquake performance

The ENDO products have gone through aseismic performance evaluation with two types of aseismic tests.



Tensile and Compression Tester

- Aseismic tests in accordance with the building equipment aseismic design/construction guideline have been performed.
- Seismic tests with the seismic waveform (actual measurement waveform) which has caused great disaster including the Great East Japan Earthquake were performed to verify the product strength against earthquake and to maintain and improve the performance.

Vibration tester
Strength against earthquake or damage during transportation is checked. Acceleration of 1.5G (value equivalent to scale 7) can be applied. Similar waveform of an earthquake occurred in the past can be reproduced.

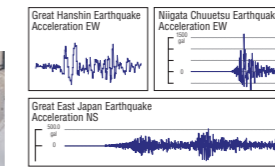

Earthquake grade (seismic scale) announced from an earthquake information is converted from the measured scale which turns the vibration intensity into a value at an observation point.

Seismic intensity scale table of the Japan Meteorological Agency

Seismic intensity scale	0	1	2	3	4	5-lower	5-higher	6-lower	6-higher	7
Measurement intensity scale	Less than 0.5	0.5 or more and less than 1.5	1.5 or more and less than 2.5	2.5 or more and less than 3.5	3.5 or more and less than 4.5	4.5 or more and less than 5.0	5.0 or more and less than 5.5	5.5 or more and less than 6.0	6.0 or more and less than 6.5	6.5 or more

High reliability under the unusual environment



Environmental Test Room



Dust Chamber

Optimum Setting for long life time

Constant temperature and constant humidity testing chamber

It is a dew point saturation type testing chamber which is used by the public testing agency. Assuming the internal and external operating environments, the temperature tests are performed to verify durability of products.



Earth-friendly design for environment



The ENDO products are environment friendly design.

ENDO provides "products conforming to environment" considering environment, and promotes reduction of environmental load in products and services through resource circulation by product recycling and through control of chemical substances contained in products.



Fluorescence X-rays Analyzer

To reduce environmentally hazardous substances, the directive (RoHS directive) to prohibit use of specific chemical substances contained in the product: cadmium (Cd), lead (Pb), mercury (Hg), hexavalent chromium (Cr+6) compound, polybromobiphenyl (PBB) and polybromodiphenylether (PBDE) has been in force in the member countries of EU (European Union) from July 1, 2006.

We have been taking actions to develop products which do not contain environmentally hazardous substances.

Endo Lighting Corp. obtained the certification of "Quality system" in the scope of "Design, development, production and additional services."
Initial registration: December, 1999 ISO9001: 1994
Revised registration: February, 2010 ISO9001: 2008
Design reviews which are performed in many steps and evaluations using the latest testing equipment are implemented. Through various processes of product planning, styling, design, quality check and product completion, we are aiming at reaching a higher level.

The Technical Center of ENDO LIGHTING Corp. obtained the certification of "Environmental system" in the scope of "Design, development, purchasing and quality assurance activities of lighting fixtures and sub-lighting fixtures."
Initial registration: June, 2007 ISO14001: 2004

TECHNICAL DATA

Service life of LED module

The service life of the white LED is defined in "JIS C 8105 - 3".
 "Total lighting time until the LED module does not turn on, or total lighting time until it falls to 70% of the measured value at the beginning of lighting, whichever is shorter, when the LED module is lit under the conditions specified by the lighting fixture manufacturer" (The "rated service life" of internal light type indicator lights that use LEDs as the light source is the time until the initial luminous flux of the light source is attenuated by 50%) We estimate the service life of the module according to these regulation.
 Since the service life of the LED module is the design service life, it is not the guaranteed service life. Also, the service life of the LED module and the service life of the lighting fixture are different.

Reliability for long service life of 40,000 hours

By designing our products with a sufficient temperature margin from the normal set value, we ensure high reliability for long service life. This also contributes to improving the reliability of the entire fixture.

Relationship graph between LED temperature and service life

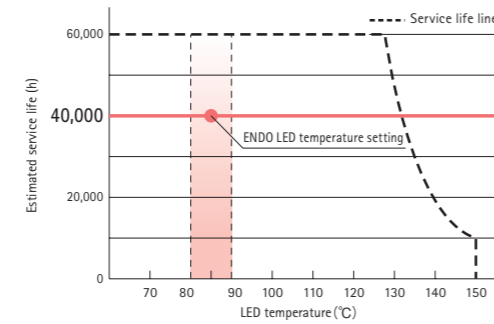

Luminous flux maintenance rate

Set according to "LED modules for general lighting service - Performance requirements (JIS C 8155)".

Comparison data of luminous flux maintenance rate

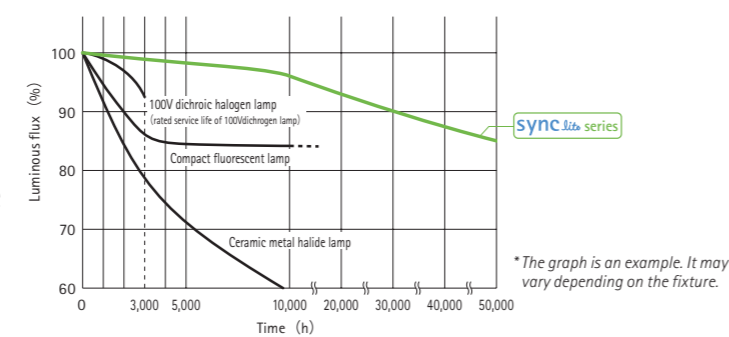

Reliability of luminous flux maintenance

The LEDZ series maintains brightness from the beginning to the end and shows a higher luminous flux maintenance rate than conventional lamps.

The replacement guideline of lighting fixtures is about 10 years, internal deterioration progresses.

Cumulative failure rate of lighting fixtures

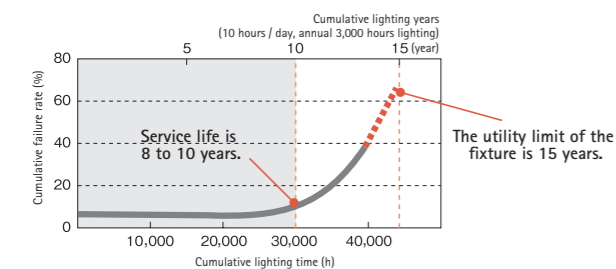

8 to 10 years after installation, internal deterioration progresses even if there is no abnormality in appearance. For safety, energy conservation and the global environment, please inspect and replace lighting fixtures that are near the end of their service life as soon as possible.

* ambient temperature 30 °C or less, 10 hours / day, annual 3,000 hours lighting
 (If the ambient temperature is higher or the lighting time is longer, the replacement timing and service life will be shortened.)
 According to the explanation of JIS C 8105-1: 2010.

Color shift of LEDs

In comparison with general light sources (fluorescent lamps or incandescent bulbs etc.), color shift of white LEDs is large, in fact. For this reason, please note that colors may vary depending on each LED lighting fixture.

Certification

Please check the certification of models on this catalogue with our website or our sales office.

WARRANTY

Product warranty

Warranty period

ENDO warrants that product sold by ENDO will be eligible for a free replacement for a period of 5 years from the date of the invoice.

* Endo assumes no responsibility for a reduction in luminous flux of the LED module within 9 % (excluding secular attenuation of the luminous flux).

* Warranty exceptions: If the lighting fixture is used for more than 20 hours per day or continuously for 24 hours a day, the product warranty period (period applicable to provision of replacement parts at no charge) shall be reduced by half.

This warranty applies to lighting fixtures and parts only; labor required for replacement, shipment cost are not included.

Drivers for linear 17, Underwater fixtures, and drivers for underwater fixtures are 2 years warranty.



Notes on modules and Driver exchange

ENDO LEDZ series general

- Please select after checking the LED units, the LED modules, and the power supply mounted on your equipment.
- Either maintenance LED units or LED modules cannot be used alone. Be sure to install it on a special fixture for use.
- Use a Driver suitable for the maintenance LED module.
- When installing a maintenance LED unit, a LED module or a Driver, please ask an expert such as an electrical construction store.
- Please be aware that if installation is not performed properly it may cause fire, falling, discoloration, deformation or shortened life or malfunction of the LEDs.
- For details on how to install a maintenance LED unit, a LED module and a Driver, please refer to the instruction manual.
- Maintenance LED unit, LED module, and the Driver are not compatible with all products listed in this catalogue.

Attention

Please note that the specifications described in this catalogue are subject to change without notice.

SALES OFFICE

Thailand

ENDO LIGHTING (THAILAND) PUBLIC COMPANY LTD.

Floor27,Unit2711-2712,Sathorn Square, 98 North Sathorn Rd, Silom Bangrak, Bangkok, 10500
 THAILAND
 T 66 2 108 1565 to66
 F 66 2 108 1562

Philippines

ENDO LIGHTING (THAILAND) PUBLIC COMPANY LTD.

Philippine Branch
 27th Floor The Enterprise Center Tower II, Paseo de Roxas Cor., Ayala Ave., Makati City, 1226 Philippines
 T63 9175503029
 T63 9175427385
 y-gotou@m1.endo-lighting.co.jp

Vietnam

ENDO LIGHTING VIETNAM CO.,LTD.

HCM Office
 5th Floor, Somerest Chancellor, 21-23 Nguyen Thi Minh Khai street District 1, Ho Chi Minh City.
 Vietnam
 T 84 28 3822 1183-6

Hanoi Rep office

Room4.9 4F Toong Co-Work space, 8 Trang Thi St.,Hoan Kiem Dist., Ha Noi
 T84 24 3266 9038
 info@endo-lighting.vn

Singapore

ENDO LIGHTING SE ASIA PTE.LTD.

8 Eu Tong Sen Street #11-86 The Central Singapore 059818
 SINGAPORE
 T 65 6333 9051
 F 65 6333 9052
 sales@endo-lighting.com.sg

United Kingdom

Ansell Sales & Distribution Limited

Unit 2, M2 Business Park
 Duncrue Street
 Belfast

Northern Ireland

BT3 9AQ

Tel: +44 28 9077 3750

Fax: +44 28 90773780

Email: sales@anselluk.com

United Kingdom

Ansell Electrical Products Limited

Unit 6B Stonecross Ind.

Park Yew Tree Way

Warrington Cheshire WA3 3JD,

United Kingdom

T +44 (0)1942 433 333

saleswarrington@anselluk.com

www.anselluk.com/

India

Endo Lighting Accessories India Private

Limited

Pune Office

Survey No 131/1B/3/2,

1st Floor, Ram indu Park Lane,

Building Behind State Bank of Mysore, Baner,

PUNE 411 045

INDIA

T 91 20 66257500

marketing@endoindia.in

China

ENDO TRADE (BEIJING) CO.,LTD.

Room 1808, Tower C, Leasing Center,

No.82 Middle Rd. Of East 4th Ring,

Chaoyang District, Beijing,

CHINA

T 86 10 8773 2670

F 86 10 8773 2822

zhaoshuai@endolighting.cn